



ALFA POMPE

ITALIAN PUMPS FOR HEAVY DUTY SOLUTION

Distributed by



Pumps and Power Australia

PRODUCT CATALOGUE | EN

INDEX

A STORY OF SUCCESS	Pag 3
THE COMPANY	Pag 4
WHY CHOOSE US	Pag 7
100% MADE IN ITALY	Pag 8
CERTIFIED COMPANY	Pag 11
100% INTERCHANGEABLE	Pag 12
CONTINUOUS INNOVATION	Pag 15
LAYOUT OF APPLICATION	Pag 16
GLOBAL SERVICE NETWORK	Pag 19
OUR BUSINESS	Pag 20
 OUR PRODUCTION	Pag 23
- Front suction pumps	Pag 25
- Horizontal axis pumps for high pressure	Pag 33
- Vertical axis pumps	Pag 45
- Submersible pumps	Pag 55
 ACCESSORIES & SUPPORT	Pag 63
- Sleeve valves	Pag 64
- Pipes and Flanges	Pag 65
- Spare parts	Pag 66
 CHOOSE YOUR COLOR	Pag 69

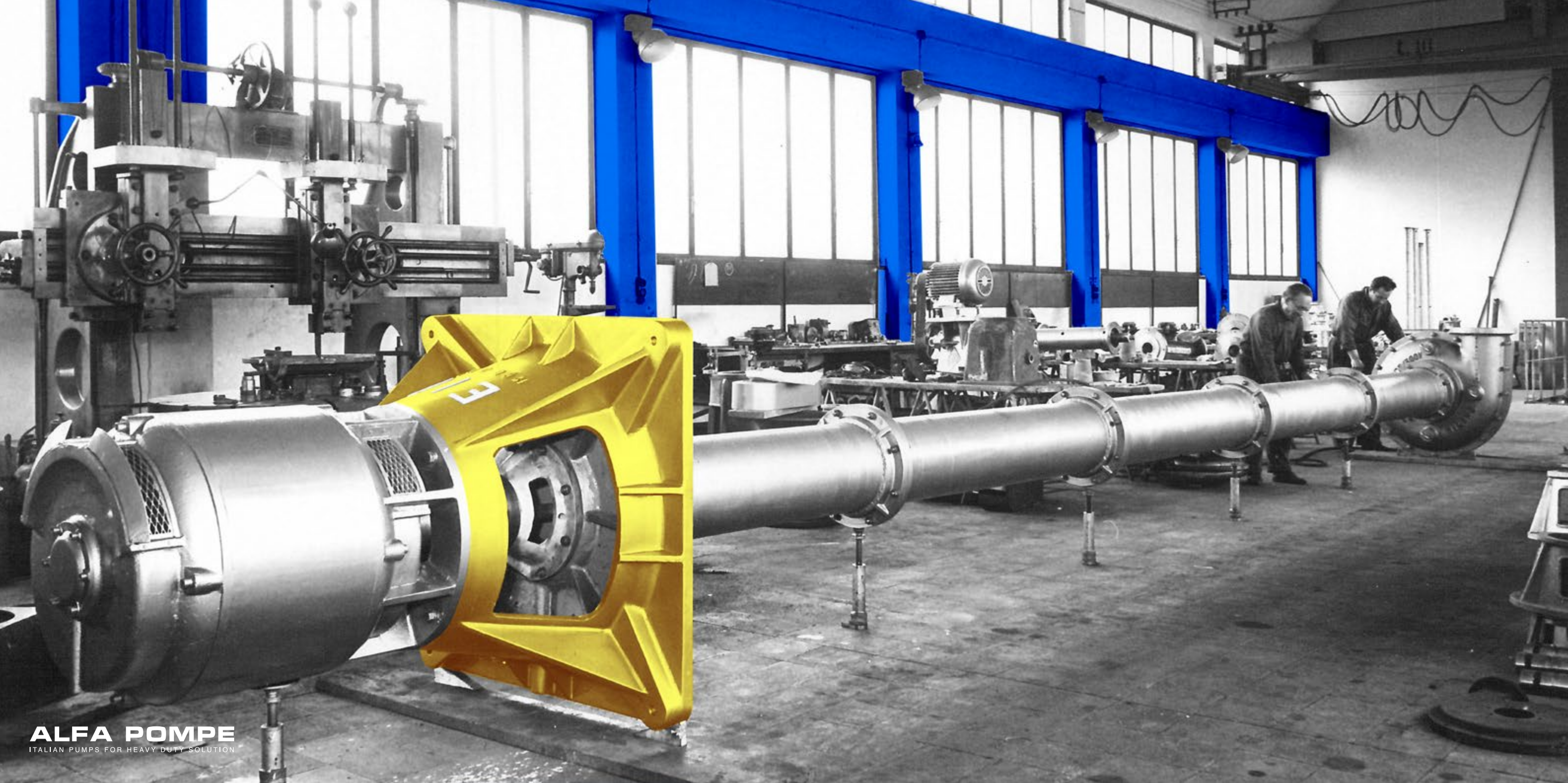

A STORY OF SUCCESS

After the end of the 'Second World War', Araldo Caprile's father founded the first company producing high-performance pumps under the name EIR.

In 1971, Araldo Caprile took over the reins of his father's company EIR, giving birth to ALFA POMPE. Alfa dedicated itself to the technical development and 100% Italian production of special rubber-coated pumps for medium and large companies working in the industrial and civil purification sectors all over the world, developing a 50-year-long experience.

After a difficult period due also to the global crisis in the early years of the new millennium, in 2020 Matec Industries decided to acquire Alfa Pompe in order to bring the brand back to global competitiveness and the splendour of the past.



1950



1971



2020



2021

ALFA POMPE

ITALIAN PUMPS FOR HEAVY DUTY SOLUTION

2024

THE COMPANY

Our Headquarters covers a total area, including workshops, offices and outdoor area, of **18000 m²** and was completely renovated in 2021, with new office space and new administrative offices. We have reinforced the staff in the offices and workshops to meet the ever-increasing demands of new and old customers, in order to provide a fast and complete all-round service.



1 - PUMP ASSEMBLY
WORKSHOP



2 - ADMINISTRATIVE
AND COMMERCIAL
OFFICES



3 - MACHINE
WORKING
DEPARTMENT



4 - OPERATION
OFFICES



5 - WAREHOUSING
AND SHIPPING





WHY CHOOSE US

Alfa is continuously developing new solutions for even the most demanding industries, such as mining, aggregate quarries, concrete mixing plants, ceramics, marble and granite processing and many others.

The performance is developed to meet any requirement for pumping abrasive liquids, acids, liquid and dense slurries. The design, materials and construction of Alfa pumps make them particularly wear-resistant and easy to maintain. The materials used to manufacture the pumps range from spheroidal cast iron to super alloys, depending on the industrial application.



PATENTS MADE IN ITALY



CONSULTING SERVICE



RESEARCH AND DEVELOPMENT



HEAVY DUTY PRODUCTS

100% MADE IN ITALY

The excellence of 'Made in Italy' is embodied in the company with a long history of tradition and innovation. Founded on the principles of high quality industry and functional design, the company stands out for its ability to combine craftsmanship with state-of-the-art technology.

The company stands out on the international scene for its ability to combine tradition and modernity, offering products that stand out for their unique and timeless style. Thanks to its established reputation around the world, the company's 'Made in Italy' label is synonymous with prestige, elegance and superior quality.



FUNCTIONAL
DESIGN



QUALITY



TECHNOLOGY



ALFA POMPE
ITALIAN PUMPS FOR HEAVY DUTY SOLUTION



CERTIFIED COMPANY

Alfa pompe, thanks to a constant commitment to innovation and continuous adherence to international standards, is positioned as a benchmark in the industry.

Every stage of production is subjected to strict controls in compliance with modern standards and the required certifications.

Certified according to strict regulations, the company is committed to ensuring the highest quality, safety and conformity in its production processes, guaranteeing customers maximum reliability and satisfaction.



**ENVIRONMENTAL
MANAGEMENT**



**HEALTH AND
SAFETY AT WORK**



**MANAGEMENT
FOR THE QUALITY**

100% INTERCHANGEABLE

Alfa Pompe offers a revolutionary solution with its pumps boasting 100% interchangeability with other market-leading brands. This unique feature ensures seamless integration and compatibility, allowing customers to effortlessly replace or upgrade their pumps without the need for extensive modifications or adjustments to existing systems.

With Alfa Pumps, customers have the freedom to choose the best pump for their specific needs without being constrained by brand limitations. Whether it concerns a centrifugal, vertical or horizontal pump, Alfa Pompe offers unrivalled versatility and reliability, ensuring consistent performance in a variety of applications.

This 100% interchangeability not only simplifies the procurement process, but also reduces downtime and maintenance costs associated with pump replacements. Alfa Pompe's commitment to excellence and innovation guarantees customers high-quality products designed to meet the highest standards of performance and durability.



**INTERCHANGEABILITY
WITH OTHER MAJOR
BRANDS**

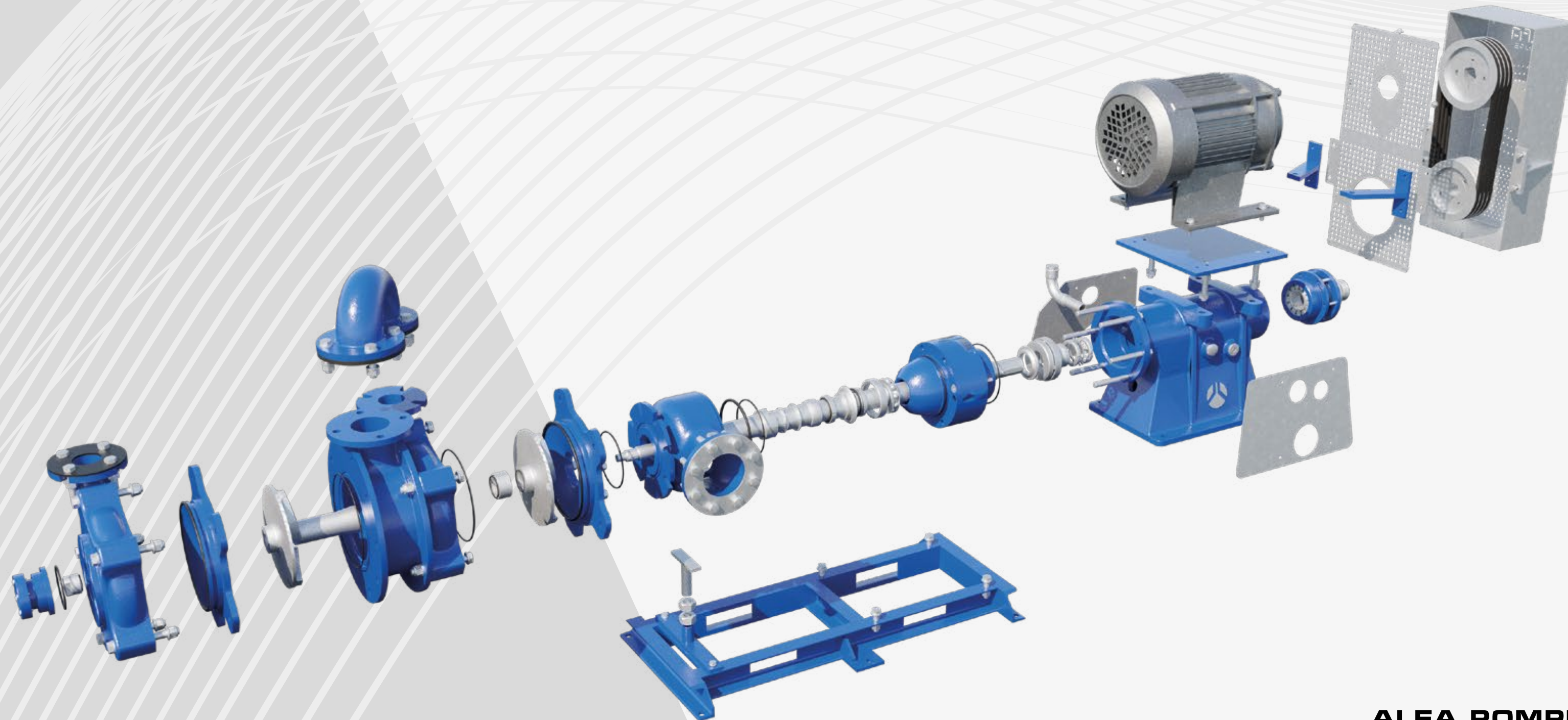

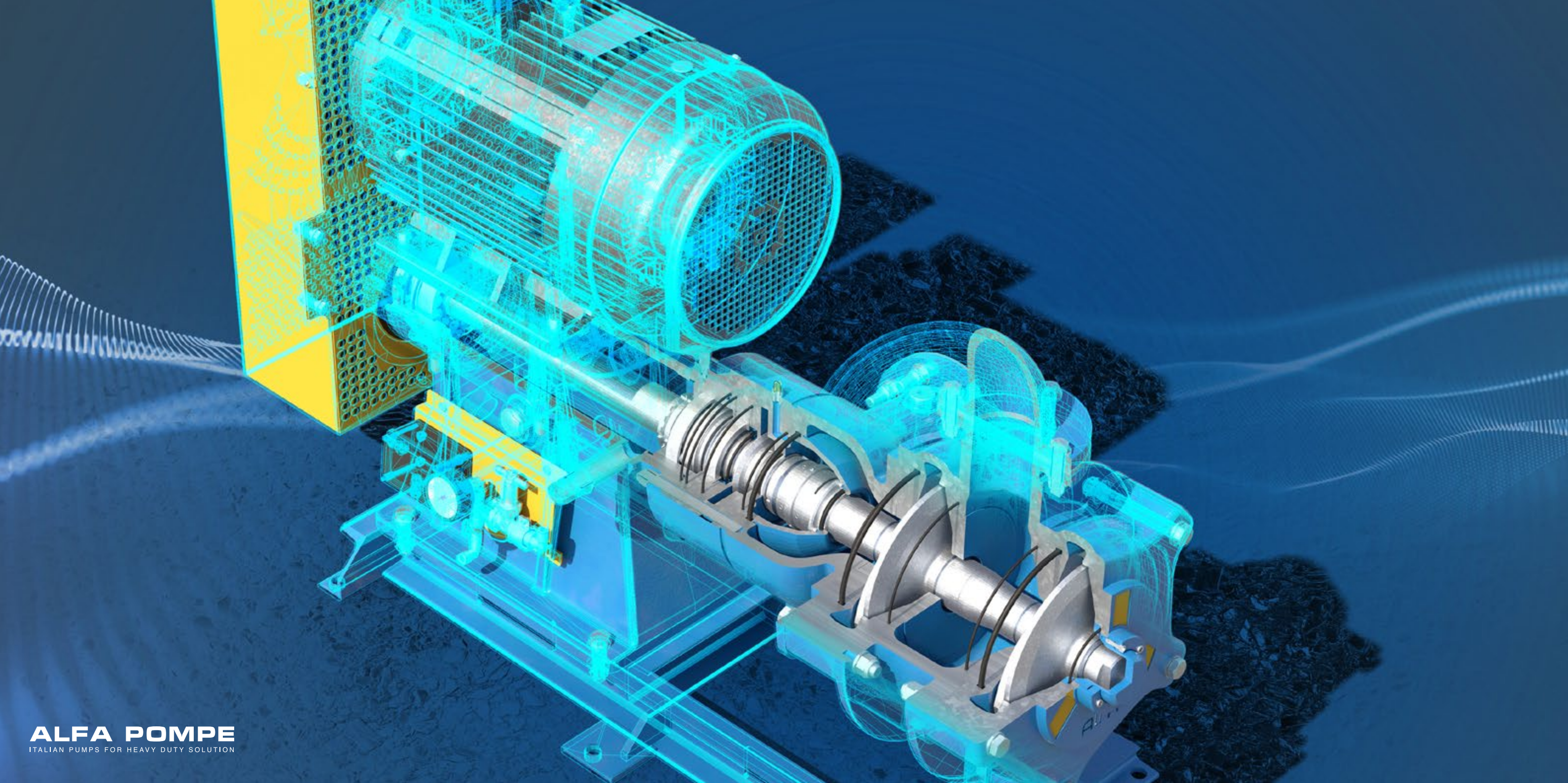

CONTINUOUS INNOVATION

Alfa Pompe is distinguished by the excellence of its products through rigorous fluid dynamics simulations. With an unwavering commitment to innovation, each pump undergoes meticulous testing to ensure maximum performance and reliability. Through the application of the most advanced technologies, Alfa Pompe ensures that each product maintains the state of the art in the industry.

Accurate simulations make it possible to optimise fluid flow and identify any areas for improvement, ensuring that the pumps always meet customers' needs with state-of-the-art performance.

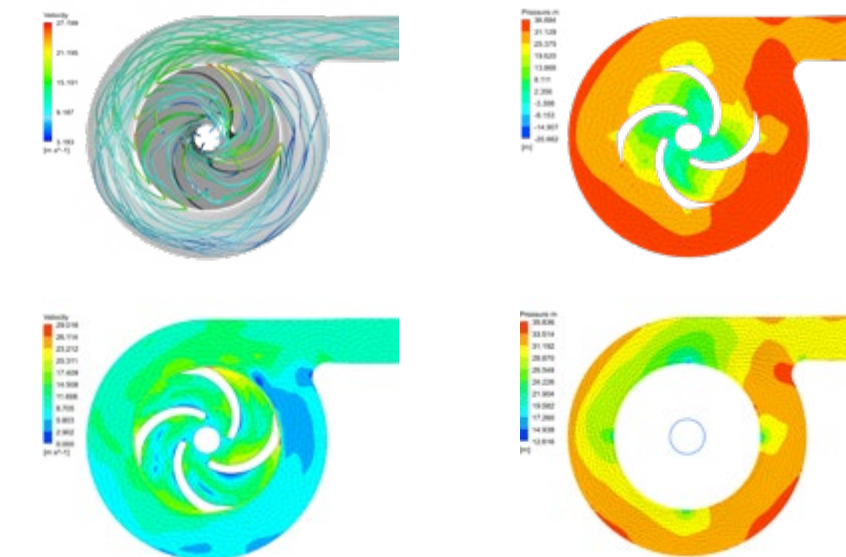

LAYOUT OF APPLICATION

Alfa Pompe excels in offering customised pumping systems for various industrial needs. With a versatile assortment, it covers every production area: from submersible sump pumps to high-pressure centrifuges for filter presses, from pumping systems for hydrocyclones to water booster pumps. Thanks to its expertise, know-how and wide range of products, it guarantees effective and reliable solutions for every industrial sector. Alfa Pompe also stands out for its ability to adapt to specific customer requirements, ensuring optimal performance and efficient management of water resources to the benefit of productivity and cost-saving.



1 - VERTICAL OR SUBMERSIBLE PUMP



2 - HORIZONTAL PUMP



3 - WALFPUMP



4 - VALVES

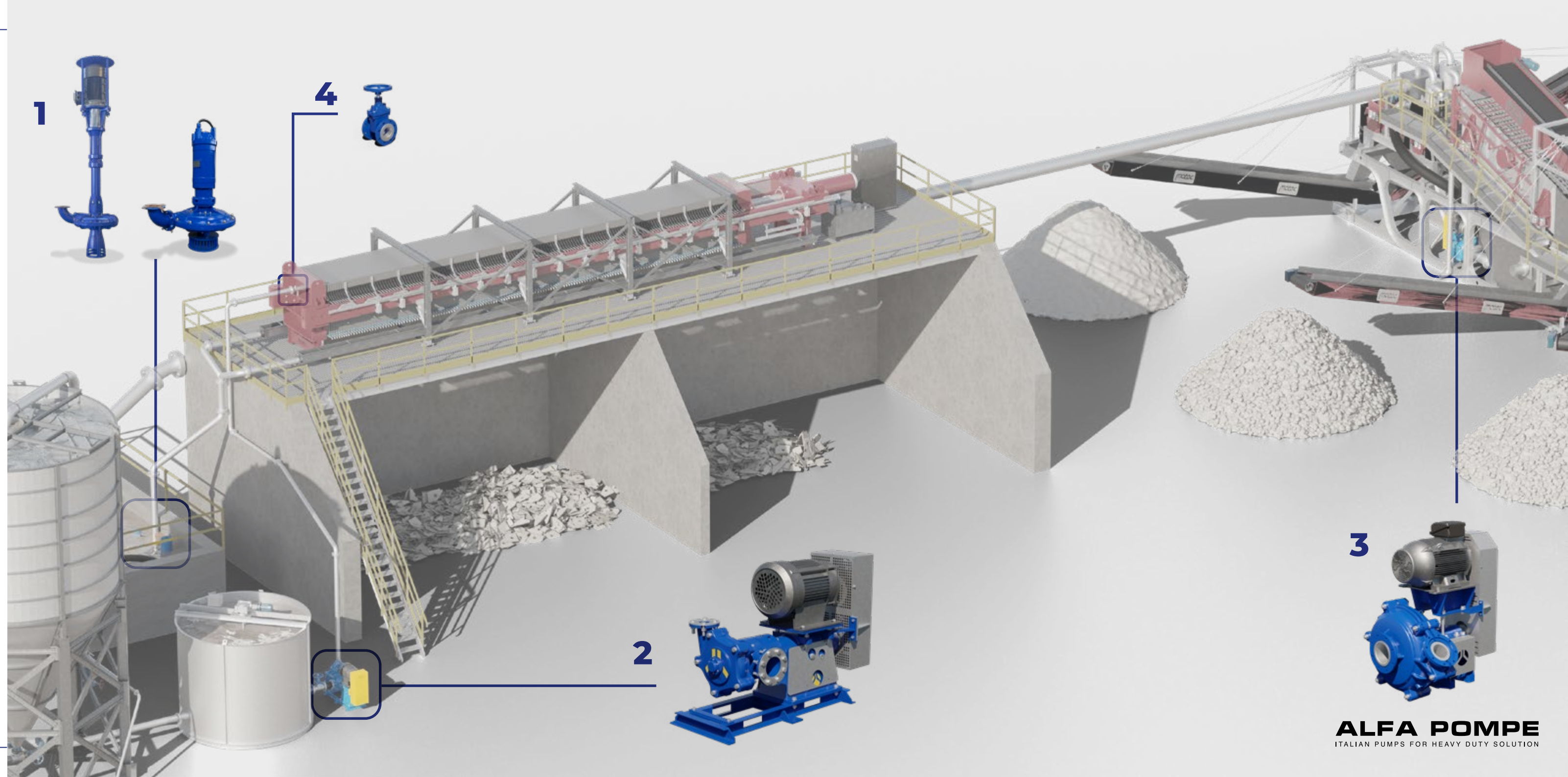

ALFA POMPE
ITALIAN PUMPS FOR HEAVY DUTY SOLUTION



GLOBAL SERVICE NETWORK

Alfa Pompe stands out for its global service, supported by the group's strategic warehouses located in Brazil, Australia, the United States and at its headquarters in Italy. This global logistics network enables Alfa Pompe to ensure timely service and availability of spare parts worldwide.

Warehouses located in different regions allow efficient stock management and rapid shipment of the components needed to maintain and repair our pumps, minimising downtime and ensuring business continuity for each of our customers.

Highly qualified technical personnel are available to provide remote support or intervene directly on site to solve any problems or provide technical advice. This customer-focused approach and quality of service allows us to establish strong, long-term relationships with customers all over the world.

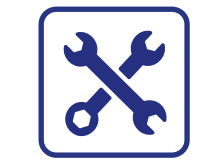

**ON-SITE
ASSISTANCE**



**SPECIALIZED
TECHNICIANS**



**24/7
SUPPORT**

OUR BUSINESS

SECTORS

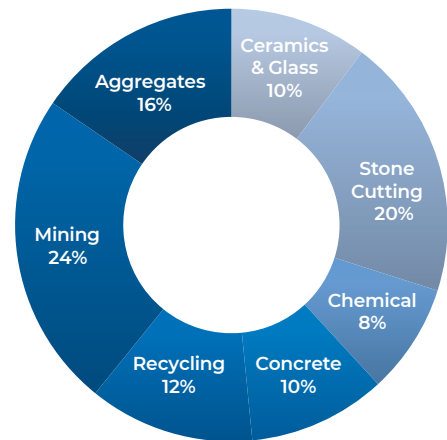

MARKET OVERVIEW

By geographical areas

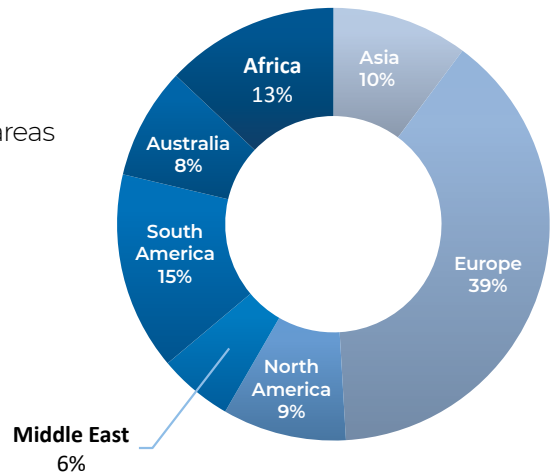



OUR PRODUCTION

FRONT
SUCTION PUMPS

Pag.
25

HORIZONTAL AXIS PUMPS
FOR HIGH PRESSURES

Pag.
33

VERTICAL AXIS
PUMPS

Pag.
45

SUBMERSIBLE PUMPS

Pag.
55

VALVES, PIPES AND FLANGES
SPARE PARTS

Pag.
63



FRONT SUCTION PUMPS

Front suction pumps are designed and engineered to feed hydrocyclones but are also used for sludge transfer or for loading filter presses.

They are characterised by front suction and can process large flow rates.

Depending on the type of application, they can be completely made of super hard cast iron or lined with abrasion resistant rubber.

In the standard version they are supplied with a packing seal (or grease cord) but it is also possible to have them with a mechanical seal.

TYPES:

WALFPUMP

M **Metallic Lined Pump**
Very abrasive materials

R **Rubber Lined Pump**
Recommended with
corrosive materials

TYPE:

WALFPUMP

FRONT SUCTION PUMPS FOR HYDROCYCLONES AND/
OR SLUDGE TRANSFER

FIELDS OF APPLICATION:

Guaranteeing high flow rates and high heads, they are ideal pumps for use in the industrial and service sectors. They are used to feed hydrocyclones in the inert treatment and washing sector and in all areas where there is a need to transfer abrasive and/or acidic liquids. The bodies and impellers can be made of cast super alloys with high resistance to mechanical abrasion (hardnesses of around 800 HB are possible), or be coated with special anti-abrasive rubber compounds.

TECHNICAL FEATURES

- AXIS:** with press-lubricated bearings
- MATCHING:** by means of belts and trapezoidal pulleys with protective casing.
- BODY:** n°1 chrome cast iron or coated with anti-abrasive rubber
- IMPELLER:** n°1 chrome cast iron closed type with hardness 790 800 HB or coated with anti-abrasive rubber.
- SEALS:** packing.
- BASE:** steel frame for floor support.

TYPES OF FLUSHES

- Lubricated gland packings
- Water-lubricated gland seals
- Water-lubricated mechanical seals

OPTIONAL

- High efficiency version (S type)
- Impeller for froth factor
- Direct coupling via mechanical coupling
- Steel frame and floor support



SECTORS

MINING
AGGREGATES
STONE
SOIL WASHING
INDUSTRIAL

MADE IN ITALY

OPERATING CHARACTERISTICS

PUMP	PIPES		FLOW RATE		HEAD	SPEED	MOTOR
	Inlet DN	Outlet DN	[M3/H]	L/1'	MH2O	[RPM]	[KW]
1.5/1B - AH	1.5	1	10 - 30	160 - 500	5 - 85	1200 - 4400	1.5 - 2.2 - 3
2/1.5B - AH	2	1.5	20 - 60	330 - 1000	6 - 60	1200 - 3200	2.2 - 3 - 4
3/2C - AH	3	2	40 - 138	660 - 2300	10 - 85	1200 - 3170	5.5 - 7.5 - 9.2 - 11 - 15
4/3C - AH	4	3	50 - 250	830 - 4160	8 - 80	1000 - 2750	11 - 15 - 18.5 - 22 - 30
4/3D - AH	4	3					37 - 45
6/4D - AH	6	4	100 - 400	1660 - 6660	10 - 78	800 - 1800	22 - 30 - 37 - 45
6/4E - AH	6	4					75 - 90
8/6E - AH	8	6	300 - 800	5000 - 13300	10 - 80	500 - 1300	30 - 37 - 45 - 55 - 75
8/6F - AH	8	6					132 - 160
10/8E - M	10	8					55 - 75 - 90
10/8F - AH	10	8	500 - 1500	8330 - 25000	10 - 85	400 - 1000	55 - 75 - 90 - 110
10/8ST - AH	10	8					315 - 355
12/10ST - AH	12	10	500 - 2000	8330 - 33300	8 - 82	300 - 900	200 - 250 - 315 - 450
14/12ST - AH	14	12	1000 - 2900	16600 - 48300	10 - 86	300 - 700	400 - 500 - 560
16/14TU - AH	16	14	1000 - 3500	16600 - 58330	10 - 62	250 - 550	≤1200
20/18U - AH	20	18	1000 - 6000	16600 - 100000	10 - 60	200 - 400	≤2000

*Sludge pressure at density 1.4 kg/dm³

PUMP	PIPES		FLOW RATE		HEAD	SPEED	MOTOR
	Inlet DN	Outlet DN	[M3/H]	L/1'	MH2O	[RPM]	[KW]
1.5/1B - AHR	1.5	1	10 - 25	160 - 400	8 - 46	1400 - 3200	1.5 - 2.2 - 3
2/1.5B - AHR	2	1.5	20 - 50	330 - 830	5 - 42	1000 - 2600	2.2 - 3 - 4
3/2C - AHR	3	2	30 - 78	500 - 1300	6 - 46	900 - 2300	5.5 - 7.5 - 9.2 - 11 - 15
4/3C - AHR	4	3	50 - 150	830 - 2500	5 - 40	800 - 1950	11 - 15 - 18.5 - 22 - 30
4/3D - AHR	4	3					37 - 45
6/4D - AHR	6	4	100 - 320	1660 - 5300	10 - 42	800 - 1350	22 - 30 - 37 - 45
6/4E - AHR	6	4					75 - 90
8/6E - AHR	8	6	200 - 680	3300 - 11300	6 - 50	400 - 1000	30 - 37 - 45 - 55 - 75
8/6F - AHR	8	6					132 - 160
10/8E - MR	10	8					55 - 75 - 90
10/8F - AHR	10	8	400 - 1050	6600 - 17500	10 - 50	400 - 750	55 - 75 - 90 - 110
10/8ST - AHR	10	8					315 - 355
12/10ST - AHR	12	10	1000 - 2300	16600 - 38300	8 - 44	300 - 650	200 - 250 - 315 - 450
14/12ST - AHR	14	12	500 - 2300	8330 - 38318	10 - 44	300 - 500	400 - 500 - 560
16/14TU - AHR	16	14	500 - 2800	8330 - 46648	10 - 42	250 - 450	≤1200
20/18U - AHR	20	18	1000 - 4500	16660 - 75000	12 - 44	200 - 350	≤2000

*Sludge pressure at density 1.4 kg/dm³

DATA SHEET - AH

PUMP	SIZE [mm]														WEIGHT [kg]
								INLET DIMENSIONS			OUTLET DIMENSIONS			OUTLET DN CURVE 45°	
	A	B	C	D	E	G	H	HOLES	H-H	EXT Ø	HOLES	H-H	EXTØ		
1.5/1B - AH	615	616	197	98	108	296	368	N° 4 HOLES Ø16	114	152	N° 4 HOLES Ø16	127	165	no curve	90
2/1.5B - AH	628	626	197	114	115,5	296	381	N° 4 HOLES Ø19	146	184	N° 4 HOLES Ø19	127	165	no curve	100
3/2C - AH	856	854	254	286	154	406	502	N° 4 HOLES Ø19	178	216	N° 4 HOLES Ø19	145	184	80 pn 16	280
4/3C - AH	884,5	929	254	340	108	406	600	N° 4 HOLES Ø22	235	279	N° 4 HOLES Ø22	192	228	100 pn 10	550
6/4D - AH	1131,5	1112,5	331	478	220	492	746	N° 4 HOLES Ø22	292	337	N° 4 HOLES Ø22	235	280	200 pn10	920
8/6E - AH	1535,5	1379	457	712	291,5	662	893	N°4 HOLES Ø22	356	406	N° 4 HOLES Ø22	324	368	200 pn10	2100
10/8E - M	1544	1410	457	701	325,5	662	756	N°8 HOLES Ø29	445	502	N°8 HOLES Ø29	375	432	200 pn10	2400
10/8F - AH	1764	1657	610	925	325,5	990	996	N°8 HOLES Ø29	445	502	N°8 HOLES Ø29	375	432	200 pn10	4500
12/10ST - AH		1827	650	1323	381	1827		N°8 HOLES Ø25	470	527	N°12 HOLES Ø25	470	528		7796
14/12ST - AH		1879	650	1482	406	1879		N°8 HOLES Ø25	521	584	N°12 HOLES Ø25	495	552		9104
16/14TU - AH		2320	900	1799	451	2320		N°12 HOLES Ø28	641	705	N°12 HOLES Ø28	610	674		
20/18U - AH		2475	900	2130	580	2475		N°12 HOLES Ø42	800	900	N°12 HOLES Ø42	800	990		

Indicative dimensions and weights

DATA SHEET - AHR

PUMP	SIZE [mm]														WEIGHT [kg]
								INLET DIMENSIONS			OUTLET DIMENSIONS			OUTLET DN CURVE 45°	
	A	B	C	D	E	G	H	HOLES	H-H	EXT Ø	HOLES	H-H	EXTØ		
1.5/1B - AHR	615	616	197	98	108	296	368	N° 4 HOLES Ø16	114	152	N° 4 HOLES Ø16	127	165	no curve	90
2/1.5B - AHR	628	626	197	114	115,5	296	381	N° 4 HOLES Ø19	146	184	N° 4 HOLES Ø19	127	165	no curve	100
3/2C - AHR	856	854	254	286	154	406	502	N° 4 HOLES Ø19	178	216	N° 4 HOLES Ø19	145	184	80 pn 16	280
4/3C - AHR	884,5	929	254	340	108	406	600	N° 4 HOLES Ø22	235	279	N° 4 HOLES Ø22	192	228	100 pn 10	550
6/4D - AHR	1131,5	1112,5	331	478	220	492	746	N° 4 HOLES Ø22	292	337	N° 4 HOLES Ø22	235	280	200 pn10	920
8/6E - AHR	1535,5	1379	457	712	291,5	662	893	N°4 HOLES Ø22	356	406	N° 4 HOLES Ø22	324	368	200 pn10	2100
10/8E - MR	1544	1410	457	701	325,5	662	756	N°8 HOLES Ø29	445	502	N°8 HOLES Ø29	375	432	200 pn10	2400
10/8F - AHR	1764	1657	610	925	325,5	990	996	N°8 HOLES Ø29	445	502	N°8 HOLES Ø29	375	432	200 pn10	4500
12/10ST - AHR		1827	650	1323	381	1827		N°8 HOLES Ø25	470	527	N°12 HOLES Ø25	470	528		7796
14/12ST - AHR		1879	650	1482	406	1879		N°8 HOLES Ø25	521	584	N°12 HOLES Ø25	495	552		9104
16/14TU - AHR		2320	900	1799	451	2320		N°12 HOLES Ø28	641	705	N°12 HOLES Ø28	610	674		
20/18U - AHR		2475	900	2130	580	2475		N°12 HOLES Ø42	800	900	N°12 HOLES Ø42	800	900		

Indicative dimensions and weights

M

R

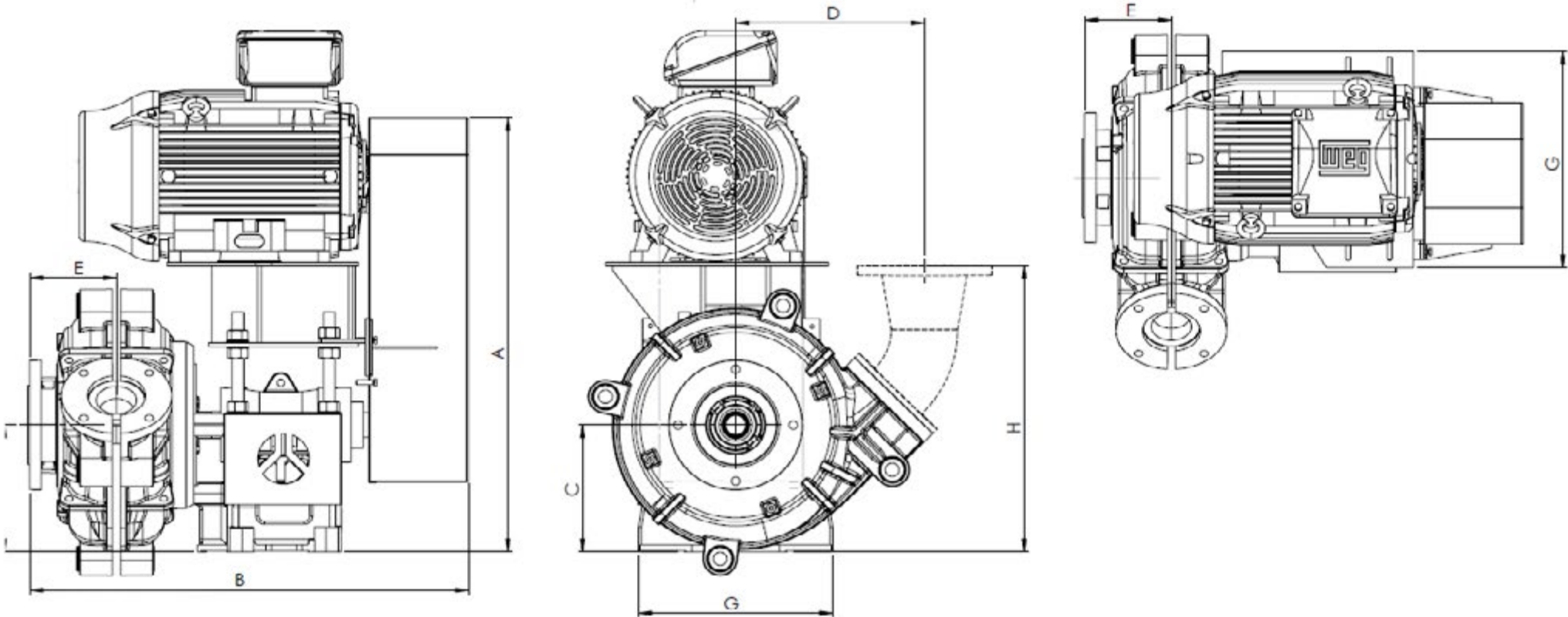

LEGEND (for illustrative purposes only)	
	Vertical discharge elevation
	On demand

MODULAR CONFIGURATIONS

Our modular technology allows the Walfpump to be customised to fit any environment. If space is limited, we can reduce the size and configure the pump to fit into a smaller space without compromising performance. Similarly, if you have a larger area available, we can expand the pump to provide greater capacity without sacrificing efficiency.

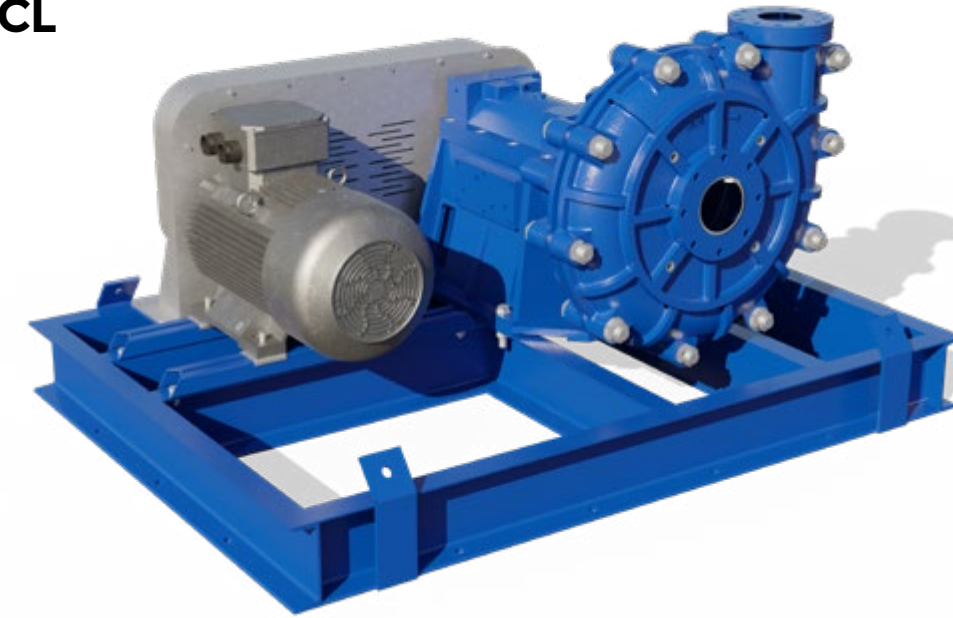
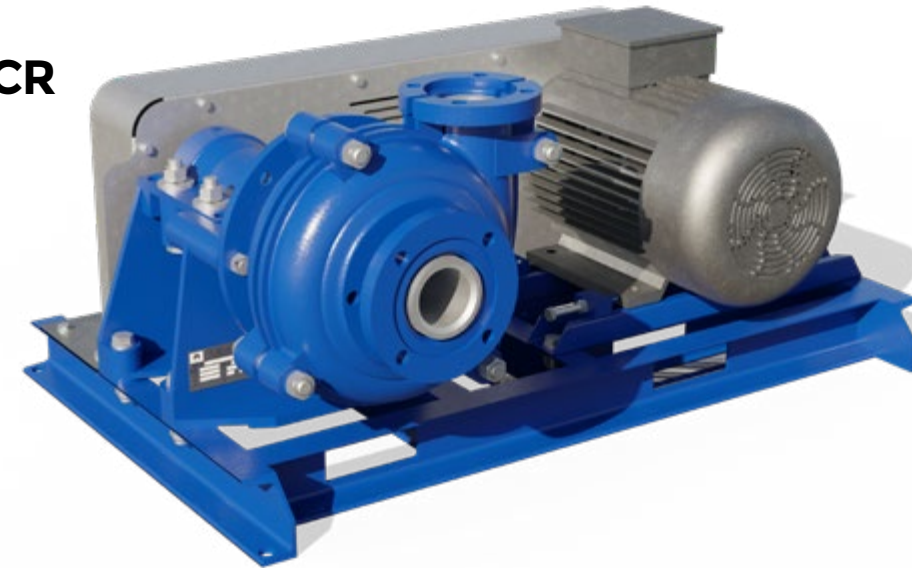
CV**ZV****CL****CR****DC**



HORIZONTAL AXIS PUMPS FOR HIGH PRESSURES

Pumps used to feed filter presses. Depending on the area of application, they can be rubberised or super hard cast iron. Superalloy pumps are specially designed for heavy duty use in mining or in the washing of aggregates. In the marble and granite industry, on the other hand, abrasion-resistant rubber linings are prevalent. Horizontal pumps for filter press can be supplied with single or double speed motors and with standard coupling by means of belts and pulleys.

TYPES:

DIABLO
DELTA
HURACAN
LEVANTE
EVO

M **Metallic Lined Pump**
Very abrasive materials

R **Rubber Lined Pump**
Recommended with
corrosive materials

TYPE:

DIABLO

HORIZONTAL SINGLE-BODY CENTRIFUGAL PUMP IN SUPERALLOY ANTI-ABRASIVE

M

FIELDS OF APPLICATION:

A horizontal axis pump mainly used to feed filter presses in the mining and aggregates sectors, also finding its way into other industries. It is a single-body pump capable of achieving a maximum closed pressure of 10 bar and a maximum flow rate range of 1000 l/min to 9000 l/min. Impeller, body and wear flange are made of super hard cast iron to withstand the maximum possible abrasion. It is equipped with tungsten carbide or silicon carbide mechanical seals flushed with clean water and oil-bath bearings. DIABLO pumps can be supplied with single or double speed motors and with standard coupling by means of belts and pulleys.

TECHNICAL FEATURES

- AXIS:** with oil-bath lubricated bearings.
- MATCHING:** by means of belts and trapezoidal pulleys with protective casing.
- BODY:** n° in chrome cast iron and vertical delivery.
- IMPELLER:** n° 1 made of dynamically balanced open-type super-alloy with a hardness of approximately 750-800HB.
- SEALS:** double mechanical seal with rings made of silicon carbide or tungsten flushed with clean water.
- BASE:** steel frame to support pump on the floor

STANDARD EQUIPMENT

- Oil temperature probe
- Flow kit with flow switch

OPTIONAL

- Pressure switch
- Bearing cooling
- Closed circuit flushing kit
- Control panel with inverter and integrated software available



SECTORS

MINING
AGGREGATES
SOIL WASHING
INDUSTRIAL

MADE IN ITALY

HPT
HIGH PRESSURE
TECHNOLOGY
10 BAR

OPERATING CHARACTERISTICS

PUMPS	MAX FLOW RATE		MAX PRESSURE		PIPES		MOTOR (4P)
	m³/h	l/l'	m/H₂o	bar*	DN Int.	DN Out.	[Kw]
DBL550-1H	70	1160	63	8	100	50	18.5-22-30
DBL650-1H	120	2000	65	8	100	50	22-30-37
DBL1025-1H	180	3000	55	7.5	150	75	30-37-45
DBL1050-1H	250	4150	70	9	200	125	37-45-55
DBL220-1H	560	9300	70	9,6	250	200	75-90

*Sludge pressure at density 1.4 kg/dm3

DIMENSIONAL

PUMPS	SIZE [mm]								WEIGHT [kg]
	A	B	C	D	E	F	G	H	
DBL550-1H	932	1223	229	161	173	373	500	601	550
DBL650-1H	961	1223	324	180	118	342	500	692	850
DBL1025-1H	1073	1288	412	208	174	491	600	755	1000
DBL1050-1H	1073	1261	510	245	223,5	491	600	798	1260
DBL220-1H	1277	1657	604	300	233,5	477	730	905	1400

Indicative dimensions and weights

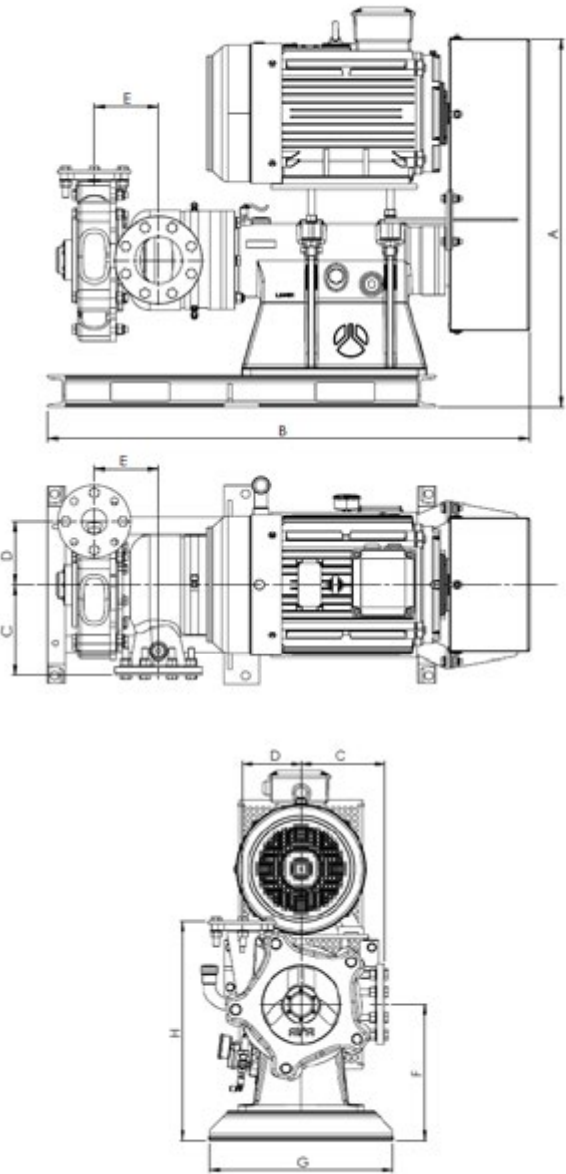

ALFA POMPE
ITALIAN PUMPS FOR HEAVY DUTY SOLUTION
DIMENSIONAL DRAWING

TYPE:

DELTA

DOUBLE-BODY HORIZONTALLY CENTRIFUGAL PUMP
IN ANTI-ABRASIVE SUPERALLOY

M

FIELDS OF APPLICATION:

A horizontal axis pump mainly used to feed filter presses in the mining and aggregates sectors, also finding its way into other industries.
It is a double-body pump capable of reaching a maximum closed pressure of 16-17 bar and a maximum flow rate range of up to 9000 l/min. Impeller, body and wear flange are made of super hard cast iron to withstand the maximum possible abrasion.
It is equipped with tungsten carbide or silicon mechanical seals flushed with clean water and oil-bath bearings.
DELTA pumps can be supplied with single or double speed motors and with standard coupling by means of belts and pulleys.

TECHNICAL FEATURES

- AXIS:** with oil-bath lubricated bearings.
- MATCHING:** by means of belts and trapezoidal pulleys with protective casing.
- BODY:** n° 2 in chrome cast iron with vertical delivery.
- SEALS:** n°2 in dynamically balanced open-type anti-abrasive super alloy with hardness of approximately 750-800HB.
- BASE:** steel frame to support the pump on the floor.

STANDARD EQUIPMENT

- Oil temperature probe
- Flow kit with flow switch

OPTIONAL

- Pressure switch
- Bearing cooling
- Closed circuit flushing kit
- Control panel with inverter and integrated software available



SECTORS

MINING
AGGREGATES
SOIL WASHING
INDUSTRIAL

MADE IN ITALY

HPT
HIGH PRESSURE
TECHNOLOGY
16 BAR

OPERATING CHARACTERISTICS

PUMPS	MAX FLOW RATE		MAX PRESSURE		PIPES		MOTOR (4P)
	m³/h	l/1'	m/H ₂ O	bar*	DN Int.	DN Out.	[Kw]
DLT550-2H	70	1160	126	16	100	50	22-30-37
DLT650-2H	120	2000	116	16	125	65	37-45
DLT1025-2H	180	3000	120	16	150	100	55-75-90
DLT1050-2H	250	4150	116	16	200	125	75-90-110
DLT220-2H	560	9300	121	16	250	200	160-200

*Sludge pressure at density 1.4 kg/dm³

DIMENSIONAL

PUMPS	DISCHARGE POSITION	DIMENSIONI [mm]								WEIGHT [kg]
		A	B	C	D	E	F	G	H	
DLT550-2H	VERTICAL	934,5	1418	229	160,5	381	372,5	500	601	950
DLT650-2H	VERTICAL	1067	1511	332	180	359	461	600	819	1250
DLT1025-2H	HORIZONTAL	1238	2174	257,5	392	535	500	880	292	1540
DLT1050-2H	VERTICAL	1237,5	2089	515,5	245	562	500	750	807	2000
DLT220-2H	HORIZONTAL	1665	2751	802	771	674	697	1090	460	4200

Indicative dimensions and weights

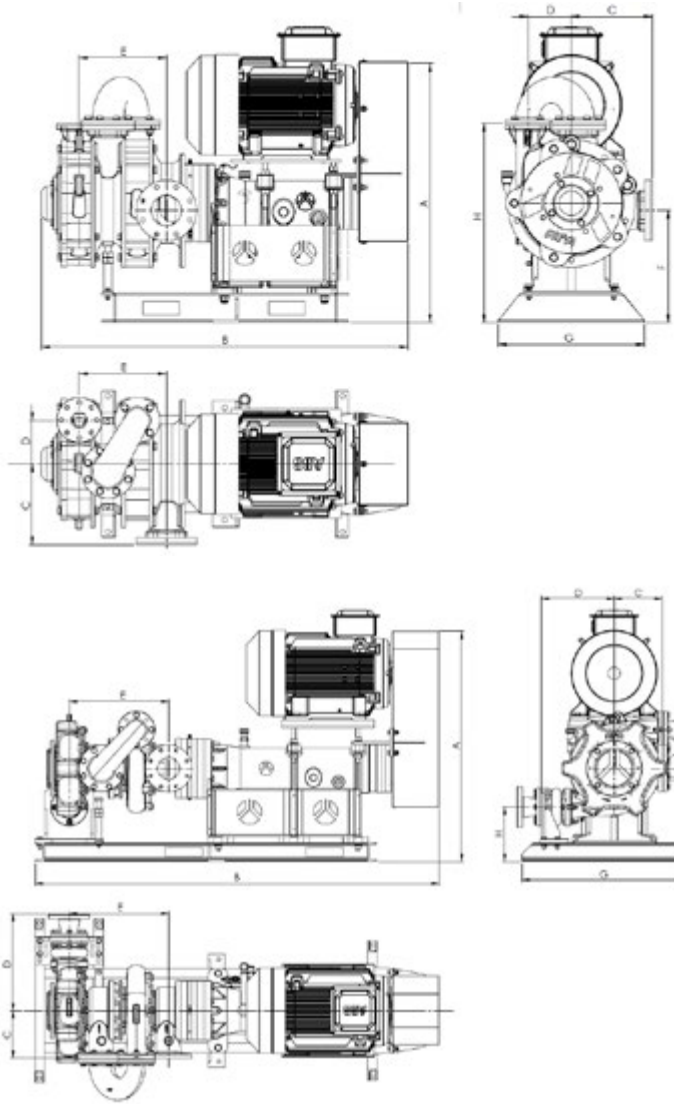

ALFA POMPE
ITALIAN PUMPS FOR HEAVY DUTY SOLUTION
DIMENSIONAL DRAWING

TYPE:

M

HURACAN

HORIZONTAL TRIPLE-BODY CENTRIFUGAL PUMP IN ANTI-ABRASIVE SUPERALLOY

FIELDS OF APPLICATION:

A horizontal axis pump mainly used to feed filter presses in the mining and aggregates sectors, also finding its way into other industries. It is a triple-body pump capable of reaching a maximum closed pressure of 20-21 bar and a maximum flow rate range of up to 4000 l/min. Impeller, body and wear flange are made of super hard cast iron to withstand the maximum possible abrasion. It is equipped with tungsten carbide or silicon carbon mechanical seals flushed with clean water and oil-bath bearings. HURACAN pumps can be supplied with single or double speed motors and with standard coupling by means of belts and pulleys.

TECHNICAL FEATURES

- AXIS:** with oil-bath lubricated bearings.
MATCHING: by means of belts and trapezoidal pulleys with protective casing.
BODY: n° 3 in chrome cast iron with vertical delivery.
SEALS: n°3 in dynamically balanced open-type anti-abrasive super alloy with hardness of approximately 750-800HB.
BASE: steel frame to support the pump on the floor.

STANDARD EQUIPMENT

- Oil temperature probe
- Flow kit with flow switch

OPTIONAL

- Pressure switch
- Bearing cooling
- Closed circuit flushing kit
- Control panel with inverter and integrated software available



SECTORS

MINING
AGGREGATES
SOIL WASHING
INDUSTRIAL

MADE IN ITALY

HPT
HIGH PRESSURE
TECHNOLOGY
21 BAR

OPERATING CHARACTERISTICS

PUMPS	MAX FLOW RATE		MAX PRESSURE		PIPES		MOTOR (4P)
	m³/h	l/l'	m/H₂o	bar*	DN Int.	DN Out.	[Kw]
HRC550-3H	70	1160	158	21	100	80	45-55-75
HRC650-3H	120	2000	150	21	125	100	55-75-90
HRC1050-3H	250	4150	150	21	200	150	110-132-160

*Sludge pressure at density 1.4 kg/dm3

DIMENSIONAL

PUMPS	SIZE [mm]								WEIGHT [kg]
	A	B	C	D	E	F	G	H	
HRC 550-3H	1227	1740	356	469.5	882	551	785	360	1430
HRC650-3H	1227	2210	332	621.5	598.5	510	960	360	2180
HRC1050-3H	1665	2815	515.5	672	901	760	1000	515	4000

Indicative dimensions and weights

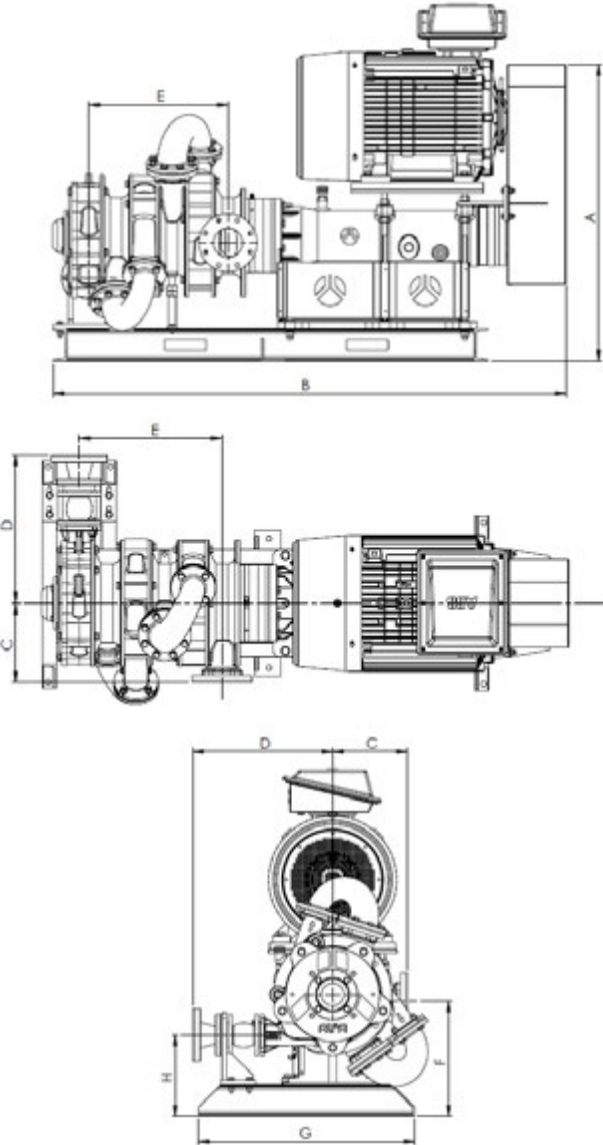

ALFA POMPE
ITALIAN PUMPS FOR HEAVY DUTY SOLUTION

DIMENSIONAL DRAWING

TYPE:

LEVANTE

RUBBERIZED HORIZONTAL SINGLE-BODY
CENTRIFUGAL PUMP

R

FIELDS OF APPLICATION:

A horizontal axis pump used to feed filter presses in the marble and granite industry, also finding its way into other industries. It is a single-body pump capable of reaching a maximum closed pressure of 6-7 bar and a maximum flow rate range of up to 4000 l/min. The impeller is made of super-hard cast iron while the body, which can be separated into two halves, is internally lined with an anti-abrasive natural rubber vulcanised onto the cast iron. It is equipped with tungsten carbide mechanical seals flushed with clean water and with bearings in an oil bath. LEVANTE pumps can be supplied with single or double speed motors and with standard coupling by means of belts and pulleys.

TECHNICAL FEATURES

- AXIS:** with oil-bath lubricated bearings.
- MATCHING:** by means of belts and trapezoidal pulleys with protective casing.
- BODY:** n° 1 cast iron in vulcanised anti-abrasive rubber.
- SEALS:** n° 1 in dynamically balanced open-type anti-abrasive super alloy with hardness of approximately 750-800HB.
- BASE:** steel frame to support the pump on the floor.

STANDARD EQUIPMENT

- Oil temperature probe
- Flow kit with flow switch

OPTIONAL

- Pressure switch
- Bearing cooling
- Closed circuit flushing kit
- Control panel with inverter and integrated software available



SECTORS

MARBLE
GRANITE
INDUSTRIAL

MADE IN ITALY

HPT
HIGH PRESSURE
TECHNOLOGY
7 BAR

OPERATING CHARACTERISTICS

PUMPS	MAX FLOW RATE		MAX PRESSURE		PIPES		MOTOR (4P)
	m³/h	l/1'	m/H ₂ O	bar*	DN Int.	DN Out.	[Kw]
LVT350-1G	20	330	30	4	65	40	5.5/11
LVT450-1G	40	660	40	5	80	50	5.5/11 - 11
LVT550-1G	60	1000	45	6	100	65	5.5/11 - 11 - 15
LVT650-1G	120	2000	55	7	125	80	15 - 18.5 - 22
LVT1025-1G	180	3000	55	7	150	100	22 - 30 - 37
LVT1050-1G	250	4150	45	6	200	150	37 - 45 - 55

*Sludge pressure at density 1.4 kg/dm3

DIMENSIONAL

PUMPS	SIZE [mm]								WEIGHT [kg]
	A	B	C	D	E	F	G	H	
LVT350-1G	795	1053	222	109.5	179	280	400	400	315
LVT450-1G	795	1074	222	101	201	280	400	464	320
LVT550-1G	702	1082	222	146	190	217	400	455	340
LVT650-1G	924.5	1144	222	181	200	388	400	425	450
LVT1025-1G	1070	1288.5	257.5	217	170	492	600	747	500
LVT1050-1G	1070	1363	300	245	291	492	600	791	570

Indicative dimensions and weights

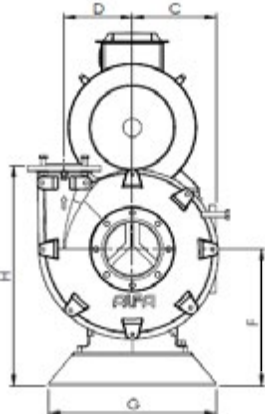
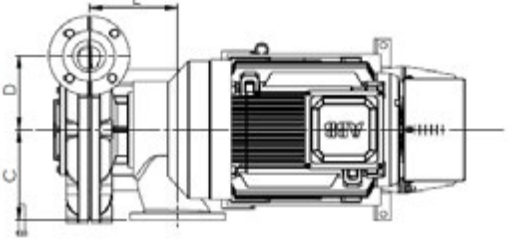
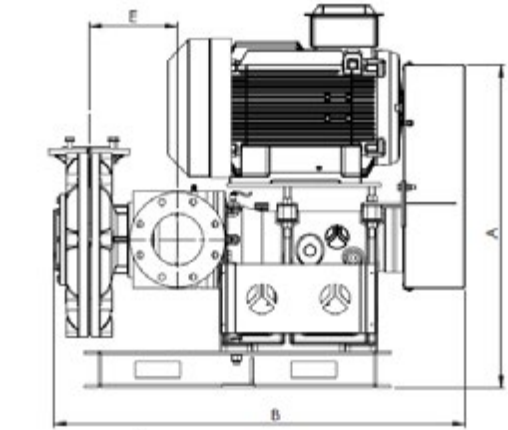

ALFA POMPE
ITALIAN PUMPS FOR HEAVY DUTY SOLUTION
DIMENSIONAL DRAWING

TYPE:

EVO

HORIZONTAL DOUBLE-BODY CENTRIFUGAL PUMP
RUBBERED

R

FIELDS OF APPLICATION:

A horizontal axis pump used to feed filter presses in the marble and granite industry, also finding its way into other industries. It is a double-body pump capable of reaching a maximum closed pressure of 12-13 bar and a maximum flow rate range of up to 4000 l/min. The impeller is made of super hard cast iron while the bodies, which can be separated into two halves, are internally lined with an anti-abrasive natural rubber vulcanised onto the cast iron. It is equipped with silicon carbide mechanical seals flushed with clean water and bearings in an oil bath. EVO pumps can be supplied with single or double speed motors and with standard coupling by means of belts and pulleys.

TECHNICAL FEATURES

- AXIS:** with oil-bath lubricated bearings.
- MATCHING:** by means of belts and trapezoidal pulleys with protective casing.
- BODY:** n° 2 in chrome cast iron with vertical delivery.
- SEALS:** n°2 in dynamically balanced open-type anti-abrasive super alloy with hardness of approximately 750-800HB.
- BASE:** steel frame to support the pump on the floor.

STANDARD EQUIPMENT

- Oil temperature probe
- Flow kit with flow switch

OPTIONAL

- Pressure switch
- Bearing cooling
- Closed circuit flushing kit
- Control panel with inverter and integrated software available

SECTORS

MARBLE
GRANITE
INDUSTRIAL

MADE IN ITALY

HPT
HIGH PRESSURE
TECHNOLOGY
13 BAR



OPERATING CHARACTERISTICS

PUMPS	MAX FLOW RATE		MAX PRESSURE		PIPES		MOTOR (4P)
	m³/h	l/1'	m/H₂O	bar*	DN Int.	DN Out.	[Kw]
EVO550-2G	70	1160	95	13	100	65	22 - 30 - 37
EVO650-2G	120	2000	95	13	125	80	30 - 37 - 45
EVO1025-2G	180	3000	100	12.5	150	100	37 - 45 - 55
EVO1050-2G	250	4150	100	13	200	150	55 - 75 - 90

*Sludge pressure at density 1.4 kg/dm³

DIMENSIONAL

PUMPS	SIZE [mm]								WEIGHT [kg]
	A	B	C	D	E	F	G	H	
EVO550-2G	1018	1549	206	146	551	365	470	603	750
EVO650-2G	1137	1861	206	182	580.5	575	800	820	1000
EVO1025-2G	1030	1650	257.5	206	528.5	451	600	707	1500
EVO1050-2G	1237	2071	504	245	741.5	500	750	800	1900

Indicative dimensions and weights

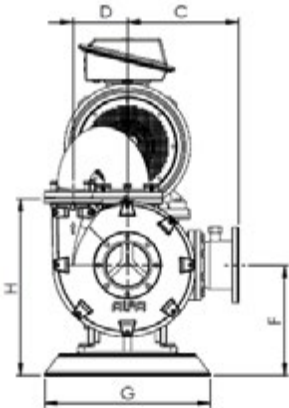
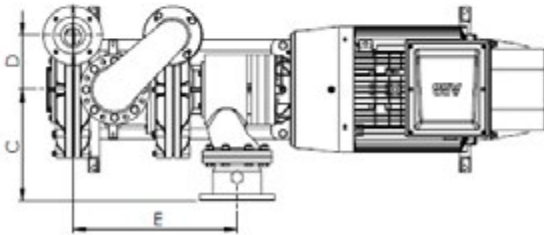
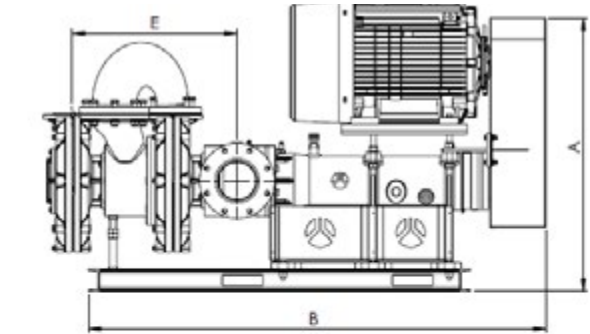

ALFA POMPE
ITALIAN PUMPS FOR HEAVY DUTY SOLUTION
DIMENSIONAL DRAWING



VERTICAL AXIS PUMPS

Vertical axis pumps for use in tanks or sumps, designed to handle sludge produced in the marble and granite industry, in mining, in the treatment/washing of aggregates or in the ceramic industry.

They are characterised by bearings dimensioned to allow the lower part of the shaft to work without supports immersed in the liquid. The bodies can be made of super hard cast iron or coated with abrasion-resistant rubber depending on the application. They can be supplied with transmission via belts and pulleys or with direct coupling via a coupling.

TYPES:

PANTERA
DRAGON
DISCOVERER
TOWER

M **Metallic Lined Pump**
Very abrasive materials

R **Rubber Lined Pump**
Recommended with
corrosive materials

TYPE:

PANTERA



ANTI-ABRASIVE VERTICAL PUMP FOR APPLICATIONS GRAVIOUS

FIELDS OF APPLICATION:

Special pumps for abrasive fluids in harsh conditions such as quarries, mines and the chemical industry. Vertical axis without submerged bearings or seals, suitable for tanks or shafts. Available in two versions: body and impeller in abrasion-resistant superalloy or rubber inner shells. Coupled to the motor by means of belts and pulleys, adjustable for performance variations.

TECHNICAL FEATURES

AXIS: vertical pump with sealed chamber bearings dimensized in such a way that the lower part of the shaft can operate cantilevered without bearings immersed in the liquid.
BODY: in chrome cast iron or coated with anti-abrasive rubber.
IMPELLER: open for large solids, cast chromium iron, closed type, 750-800 HB hardness or coated with abrasion-resistant rubber.

OPTIONAL

- Complete immersed portion (L) can be dimensioned on request.



SECTORS

MARBLE
GRANITE
AGGREGATES
RECYCLING
MINING

MADE IN ITALY

OPERATING CHARACTERISTICS

PUMPS	FLOW RATE																MOTOR*
	m³/h l/m	10	20	30	40	60	80	100	200	300	400	500	600	800	1000	1500	
PNT 40 PV/SP		5,5	4,2														1000
		15,4	13,2	11,5	9,3												1600
		28	27,5	24,5	22												2200
PNT 65 QV/SP		5,2	4,8	4,4	4												600
			28	27,6	26,8	24,9	22,5	20									1400
			57,3	57	56,1	54,1	51,7	48,5									2000
PNT 100 RV/SP				6,3	6,2	6	5,8	5,3									500
					25,4	25,2	25	24,5	21,6								1000
					50	49,9	49,7	49,4	46,3	40,8							1400
PNT 150 SV/SP								9	8	6,5							500
								23,7	22,6	20,9	18,8	16					800
								37,3	36,2	34,4	32	29,1	26				1000
PNT 200 SV/SP								8,8	8	7,3	6,6						400
									22,6	21,7	20,5	19,3	18				650
									39,2	38,1	36,9	35,5	33,9	30,5	27		850
PNT 250 TV/SP									9,8	9,4	9	8,3	7,7				400
									22,3	21,9	21,4	20,8	20	18,2			600
									35,2	34,8	34	33,4	32,6	30,9	28,5		750
PNT 300 TV/SP									7	6,7	6,4	6,1	5,8	4,9			350
									17,8	17,2	16,8	16,4	16	15,1	13,8		550
									28,9	28,4	27,9	27,4	26,9	25,6	24,6	20,8	700

*Indicative data; measurement made with water; motor sizes and may vary when working with high density sludge.

DIMENSIONAL

PUMPS	DIMENSIONI mm																			PESO Kg				
	A	B	C	D	E	F	G	H	I	J	K	L	M	N	P	Q	S	T	U		V	W	Y	Z
PNT 40 PV/SP	Ø290	Ø230	75	85	133,5	4	16	18	374	153	285	900	130	88	DISCHARGE FLANGE 127 Ø 0.Ø - 40 I.Ø 4 HOLES Ø16 ON Ø98	N°4 - Ø18	450	500	450	500	Ø255	N°8 - Ø15	205	285
PNT 40 PV/SPR																							260	
PNT 65 QV/SP	Ø362	Ø280	95	110	178	5	20	21	492	232	399	1200	227	123	DISCHARGE FLANGE 180 Ø 0.Ø - 65 I.Ø 4 HOLES Ø19 ON Ø140	N°4 - Ø18	620	680	620	680	Ø320	N°8 - Ø19	285	432
PNT 65 QV/SPR																							400	
PNT 100 RV/SP	Ø500	Ø400	155	170	238	6	28	26	663	310	515	1500	265	195	DISCHARGE FLANGE 229 Ø 0.Ø - 104 I.Ø 8 HOLES Ø19 ON Ø191	N°4 - Ø22	930	1000	800	870	Ø445	N°8 - Ø23	400	867
PNT 100 RV/SPR																							800	
PNT 150 SV/SP	Ø680	Ø550	200	211	300	5	20	25	878	375	665	1800	396	230	DISCHARGE FLANGE 280 Ø 0.Ø - 152 I.Ø 8 HOLES Ø22 ON Ø241	N°4 - Ø28	1030	1100	1030	1100	Ø610	N°8 - Ø27	500	1737
PNT 150 SV/SPR																							1500	
PNT 200 SV/SP	Ø680	Ø550	200	211	300	10	32	32	878	439	771	1800	457	230	DISCHARGE FLANGE 343 Ø 0.Ø - 200 I.Ø 8 HOLES Ø22 ON Ø298	N°4 - Ø28	1200	1300	1100	1200	Ø610	N°8 - Ø27	600	2800
PNT 250 TV/SP	Ø860	Ø650	200	220	345	10	40	30	1338	471	903	2100	495	300	DISCHARGE FLANGE 406 Ø 0.Ø - 250 I.Ø 12 HOLES Ø25 ON Ø362	N°4 - Ø28	1650	1750	1350	1450	Ø760	N°8 - Ø39	700	3100
PNT 300 TV/SP	Ø860	Ø650	200	220	345	10	40	30	1338	583	942	2100	495	300	DISCHARGE FLANGE 483 Ø 0.Ø - 300 I.Ø 12 HOLES Ø25 ON Ø432	N°4 - Ø28	1650	1750	1350	1450	Ø760	N°8 - Ø39	700	3500

Indicative dimensions and weights

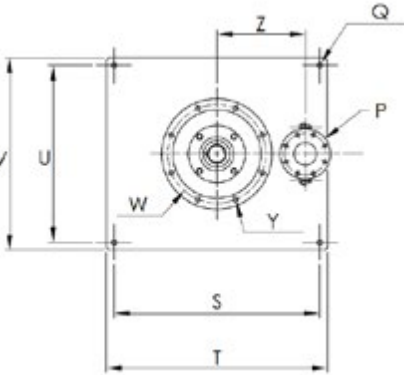
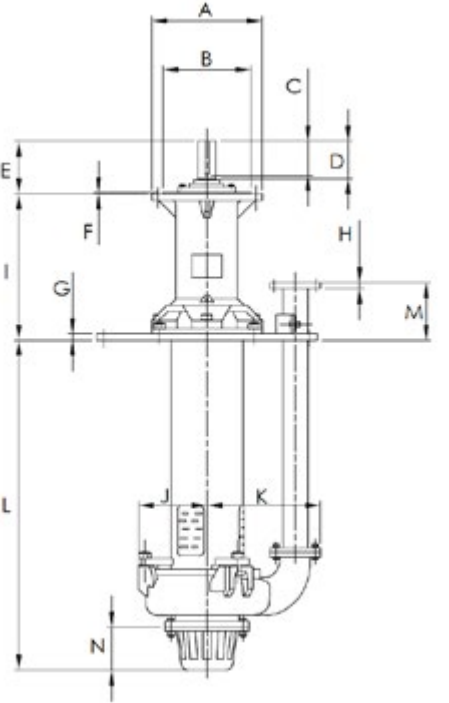

ALFA POMPE
ITALIAN PUMPS FOR HEAVY DUTY SOLUTION

DIMENSIONAL DRAWING

DRAGON



FIELDS OF APPLICATION:

Special pumps for abrasive liquids from stone, aggregates, cement water, glass and ceramics.
Direct coupling via elastic coupling.
Flow rate up to 5800 l/min.

TECHNICAL FEATURES

AXIS: vertical with sealed chamber bearings dimensioned in such that the lower part of the shaft can work cantilevered without supports immersed in the liquid.

BODY: cast iron, split in two parts, coated with wear-resistant compound. Replaceable and adjustable antiabrasive rubber shells for quick maintenance

DISCHARGE CURVE: with interchangeable rubber sleeve for connecting the pump to the delivery hose.

IMPELLER: anti-clogging open metal that improves efficiency, allowing smaller engines the same performance.

OPTIONAL

On request, it is possible to insert an extension between the suction pad and the lower body bottom to increase the distance between bearing and liquid and keep the motor outside the bowl.



SECTORS

**MARBLE
GRANITE
AGGREGATES
RECYCLING
MINING**

MADE IN ITALY

OPERATING CHARACTERISTICS

PUMPS	FLOW RATE									SPEED [RPM]	MOTOR*
	m³/h	0	50	100	150	200	250	300	350		
	l/l'	0	834	1667	2501	3334	4168	5001	5835		
DRG 125 Ø 330	HEAD (m)	37	35,5	33	28	22,5				1450	30kw
DRG 125 Ø 350		42	40,5	38	35	31	26,5	22		1450	37kw
DRG 125 Ø 370		47	45,5	43,5	41	37,5	34	29,5	25	1450	45kw
DRG 125 Ø 400		54,5	54	52	49	46	42,5	38	33	1450	55kw

*Indicative data; measurement made with water; motor sizes and may vary when working with high density sludge.

DIMENSIONAL

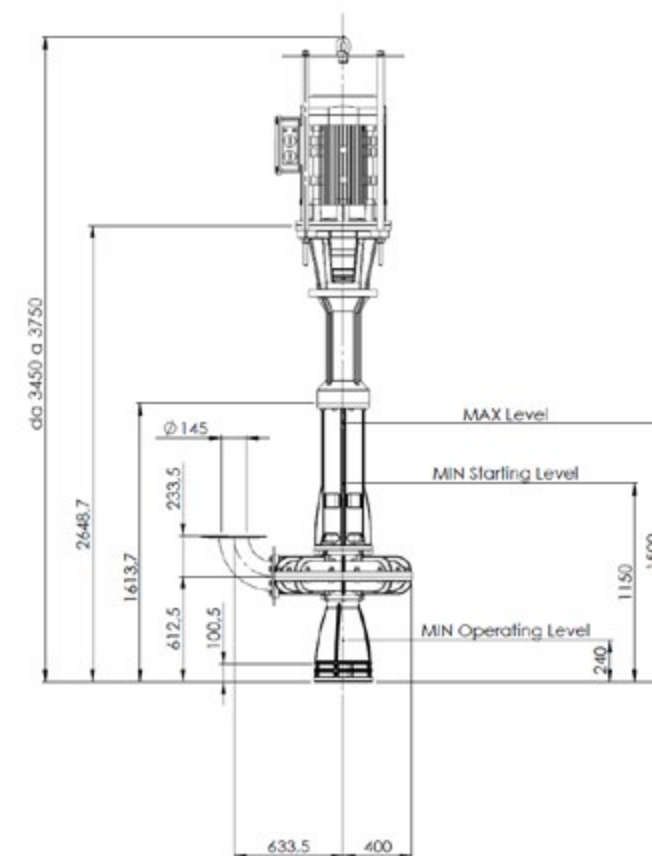
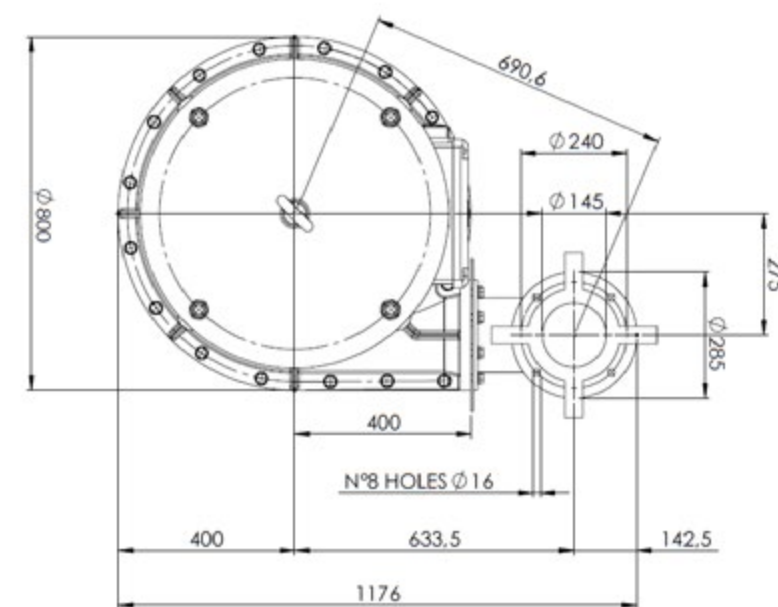

ALFA POMPE
ITALIAN PUMPS FOR HEAVY DUTY SOLUTION

DIMENSIONAL DRAWING

TYPE:

DISCOVERER

R

VERTICAL PUMP WITH DIRECT DRIVE

FIELDS OF APPLICATION:

Special pumps for abrasive liquids such as stone, aggregates, cement waters, glass, and ceramics.

TECHNICAL FEATURES

- AXIS:** Vertical pump with sealed chamber bearings for work in cantilever without immersed supports.
- BODY:** Cast iron, divided into two parts, coated with wear-resistant compound. Replaceable and adjustable anti-abrasive rubber shells for quick maintenance.
- DISCHARGE CURVE:** With interchangeable rubber sleeve for connecting the pump to the discharge pipe.
- IMPELLER:** Non-clogging open type, consisting of a steel core coated in a special anti-abrasive compound.

OPTIONAL
Upon request, it is possible to insert an extension between the suction pipe and the lower BODY to increase the distance between the bearing and the liquid, thus keeping the motor outside the tank.



SECTORS

MARBLE
GRANITE
AGGREGATES
RECYCLING
MINING

MADE IN ITALY

OPERATING CHARACTERISTICS

PUMPS	FLOW RATE																												SPEED (RPM)	MOTOR*
	m³/h	6	9	12	18	24	30	45	60	75	90	105	120	135	150	180	210	240	270	300	330	360	390	420	450	480	510	540	570	
29	19	18	17	14	10,5																								2860	4 kW
45	11	10,5	10	8,5	7																								1425	4 kW
75				17,5	17	16,5	15	13	11																				1455	7.5 kW to 22 kW
75S					20,5	20	18,5	16,5	14,5	12																			1460	
100						18,5	18	17	16	15	13,5	12	10																970	11 kW to 30 kW
121							18,5	18	17,5	16,5	16	15,5	15	13,5	12	10													970	
123									21	20,5	20	19,5	19	18	17	15,5	13,5	12	10										975	30 kW to 45 kW
125										22,5	22	21,5	21	20	18,5	17	15,5	13,5	11,5										975	
160											19,5	19	18,5	18	17,5	17	16	15	14	13	12	11	10						980	
198/435															18,5	18	17,5	17	16,5	16	15,5	14,5	14	13	12	11			740	37 KW to 55 KW
200															22,5	22	21,5	21	20	19	18	17	16	15	14	13			980	55 KW to 75 KW

*Indicative data; measurement made with water; motor sizes and may vary when working with high density sludge.

DIMENSIONAL

PUMPS	SIZE (mm)										WEIGHT (Kg)
	A	B	C	D	E	F	G	H	M	N	
29	1755	780	310	165	125	140	325	250	50	1290	135
45	1755	780	310	165	125	175	370	250	50	1290	142
75	2690	1050	415	200	105	260	475	330	100	1990	360
75S	2690	1050	415	200	105	260	475	330	100	1990	375
100	3355	1450	515	205	115	360	580	400	100	2550	730
121	3340	1500	615	420	145	400	610	500	125	2600	790
123	3505	1500	615	420	145	400	610	500	150	2630	910
125	3505	1500	615	420	145	400	610	500	150	2630	950
160	3965	1750	840	310	210	450	810	700	175	2870	1130
198/435	4105	1750	840	315	210	465	775	700	200	2910	1650
200	3965	1750	840	310	210	450	810	700	175	2870	1300

Indicative dimensions and weights

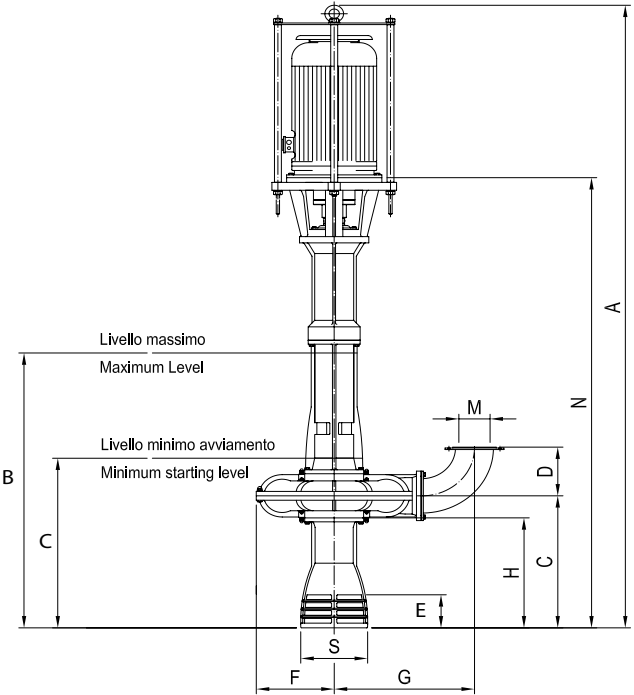

ALFA POMPE
ITALIAN PUMPS FOR HEAVY DUTY SOLUTION

DIMENSIONAL DRAWING

TYPE:

TOWER

VERTICAL PUMP WITH BELT DRIVE
AND PULLEYS

FIELDS OF APPLICATION:

Special pumps for abrasive liquids such as stone, aggregates, cement waters, glass, and ceramics.

TECHNICAL FEATURES

AXIS: Vertical pump with sealed chamber bearings for working cantilevered without immersed supports.

BODY: Made of cast iron, divided into two parts, coated with wear-resistant compound.

Replaceable and adjustable anti-abrasive rubber shells for quick maintenance.

DISCHARGE CURVE: Equipped with interchangeable rubber sleeve for connecting the pump to the discharge pipe.

IMPELLER: Non-clogging open type impeller, consisting of a steel core coated with a special anti-abrasive compound.

OPTIONAL

Upon request, it is possible to insert an extension between the suction pipe and the lower BODY to increase the distance between the bearing and the liquid, thus keeping the motor outside the tank.

R



SECTORS

MARBLE
GRANITE
AGGREGATES
RECYCLING
MINING

MADE IN ITALY

OPERATING CHARACTERISTICS

PUMPS	FLOW RATE																									MOTOR*
	m³/h l/m	12 200	18 300	24 400	30 500	45 750	60 1000	75 1250	90 1500	105 1750	120 2000	135 2250	150 2500	180 3000	210 3500	240 4000	270 4500	300 5000	330 5500	360 6000	390 6500	420 7000	450 7500	480 8000	SPEED (RPM)	
TWR 75			17,5	17	16,5	15	13	11																	1455	7.5kW to 22kW
				26	25,5	23,5	21,5	19																	1750	
				30	29,5	28	25,5	23																	1900	
TWR 75S				20,5	20	18,5	16,5	14,5	12																1460	11kW to 30kW
				30,5	30	28,5	26,5	24,5	21,5																1750	
						18,5	18	17	16	15	13,5	12	10												970	
TWR 100						23	22	21	20	18,5	17	15,5	13,5												1100	30kW to 45kW
						25	24	23	21,5	20	18,5	17	15												1150	
							18,5	18	17,5	16,5	16	15,5	15	13,5	12	10	8								970	
TWR 121								23	22,5	22	21,5	21	20	18,5	16,5	14,5	12,5								1100	55kW to 75kW
								25	24,5	24	23,5	22,5	21,5	20	18,5	16,5	14,5								1150	
								21	20,5	20	19,5	19	18	17	15,5	13,5	12	10							975	
TWR 123								27	26,5	26	25,5	25	24	23	21,5	19,5	17,5	15							1100	
								29	28,5	28	27,5	27	26	24,5	23	21	19	17							1150	
								23	22,5	22	21,5	20,5	20	18,5	17	15,5	13,5	11,5							975	
TWR 125								26	25,5	25	24,5	23,5	22	20,5	19	17	15								1050	30kW to 45kW
								29	28,5	28	27	26	25	23,5	21,5	19,5	17								1100	
									20	19,5	19	18,5	18	17,5	17	16	15	14	13	12	11	10			980	
TWR 160										23	22,5	22	21,5	20,5	20	19	18	17	16	15	14				1050	
										25,5	25	24,5	24	23,5	22,5	21,5	20,5	19,5	18,5	17,5	16				1100	
											23	22,5	22	21,5	20,5	20	19	18	17	16	15	14	13		980	
TWR 200													26,5	26	25,5	24,5	24	23	22	21	20	19	17,5	16	1050	55kW to 75kW
													29	28,5	28	27	26	25	24	23	22	21	19,5	18,5	1100	

*Indicative data; measurement made with water; motor sizes and may vary when working with high density sludge.

DIMENSIONAL

PUMPS	SIZE (mm)												WEIGHT (Kg)
	A	B	C	D	E	F	G	H	M	N	S	T	
TWR 75	2630	1050	415	200	105	260	475	330	100	1925	270	395	390
TWR 75S	2630	1050	415	200	105	260	475	330	100	1925	270	395	415
TWR 100	3300	1450	515	205	115	360	580	400	100	2485	280	485	770
TWR 121	3350	1500	615	420	145	400	610	500	125	2535	240	485	840
TWR 123	3410	1500	615	420	145	400	610	500	150	2535	340	595	965
TWR 125	3410	1500	615	420	145	400	610	500	150	2535	340	595	1015
TWR 160	3870	1750	840	310	210	450	810	700	175	2775	385	595	1190
TWR 200	3870	1750	840	310	210	450	810	700	175	2775	385	595	1340

Indicative dimensions and weights

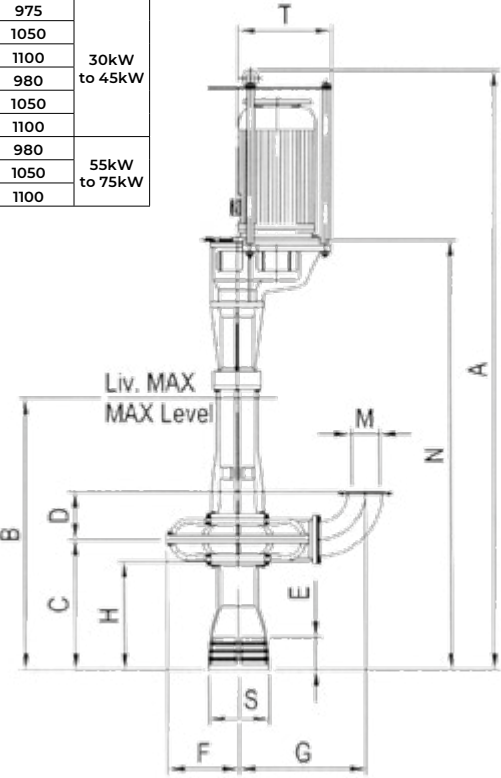

ALFA POMPE
ITALIAN PUMPS FOR HEAVY DUTY SOLUTION
DIMENSIONAL DRAWING



SUBMERSIBLE PUMPS

Vertical AXIS pumps that can be fully immersed in the tank or well. Designed to handle sludges produced in the marble and granite industry, in mining, in the processing/washing of aggregates, or in the ceramic sector. One of the features of these pumps is the direct fitting of the impeller onto the motor shaft.

The bodies can be made of super-hard cast iron or coated with anti-abrasive rubber depending on the application.

TYPES:

BARRACUDA
NAUTILUS
SHARK

M **Metallic Lined Pump**
Very abrasive materials

R **Rubber Lined Pump**
Recommended with
corrosive materials

TYPE:

BARRACUDA

M

SUBMERSIBLE WASTEWATER TREATMENT PUMP

FIELDS OF APPLICATION:

Submersible pumps designed and engineered for the treatment of wastewater in INDUSTRIAL, domestic, and agricultural sectors. The flow range of these pumps varies from 200 l/min to 10,000 l/min with power ranging from 4 kW to 45 kW. These pumps are mechanically sealed and have the BODY and IMPELLER made of cast iron, while the shaft is made of steel.

TECHNICAL FEATURES

- AXIS:** Vertical AXIS pump with IMPELLER directly connected to the motor shaft with oil bath lubricated bearings.
- BODY:** Made of cast iron, divided into two parts and coated with wear-resistant compound. Replaceable and adjustable anti-abrasive rubber shells for quick maintenance.
- IMPELLER:** Non-clogging open type impeller, consisting of a steel core coated with a special anti-abrasive compound.

STANDARD EQUIPMENT

- Humidity probe
- Temperature probe



SECTORS

MARBLE
GRANITE
AGGREGATES
RECYCLING
INDUSTRIAL

MADE IN ITALY

OPERATING CHARACTERISTICS

PUMPS	FLOW RATE													SPEED (RPM)	MOTOR* (kW)
	m³/h	12	24	36	48	60	90	120	180	240	300	360	600		
	l/1'	200	400	600	800	1000	1500	2000	3000	4000	5000	6000	10000		
BRC 100 - 4	HEAD (m)	11,7	11,6	11,5	11,3	11	9,5	-	-	-	-	-	-	1450	4
BRC 100 -7.5		22,4	22,6	23	22,7	22,2	21	-	-	-	-	-	-	1425	7,5
BRC 100 -11			30	29,7	29,5	28,6	26	20							
BRC 150 - 15		-	-	17,4	17,4	17,4	17,2	16,8	14,9	-	-	-	-	1455	15
BRC 150 - 18.5				23,3	23,2	23	22,8	22,3	19,7						
BRC 200 - 22		-	-	-	-	19,5	19,2	18,8	18,1	16,7	14,6	12,5	-	1450	22
BRC 200 - 30		-	-	-	-	-	19,4	19,2	18,7	17,8	16,6	15	-	1450	30
BRC 250 - 37		-	-	-	-	-	-	19,1	18,7	18,1	17,5	16,7	11,1	1450	37
BRC 250 - 45		-	-	-	-	-	-	22,2	21,7	21,1	20,6	19,7	15,1	1450	45

*Indicative data; measurements conducted with water; motor sizes may vary when operating with high-density sludges.

DIMENSIONAL

PUMPS	SIZE (mm)							
	A	B	C	D	E	F	G	H
BRC 100 - 4	600	400	130	Ø100	170	210	350	N°4 - Ø18
BRC 100 - 7,5	745	510	170	Ø100	170	Ø210	430	N°4 - Ø18
BRC 100 - 11	920	570	170	Ø100	170	Ø210	480	N°4 - Ø18
BRC 150 - 15	980	660	255	Ø150	225	Ø265	590	N°8 - Ø18
BRC 150 - 18.5	1090	700	255	Ø150	225	Ø265	590	N°4 - Ø18
BRC 200 - 22	1230	830	290	Ø200	280	Ø320	580	N°8 - Ø18
BRC200 - 30	1170	780	290	Ø200	280	Ø320	680	N°8 - Ø18
BRC250 - 37	1420	950	345	Ø250	335	Ø375	780	N°12 - Ø18
BRC250 - 45	1530	1000	345	Ø250	335	Ø375	780	N°12 - Ø18

Indicative dimensions and weights

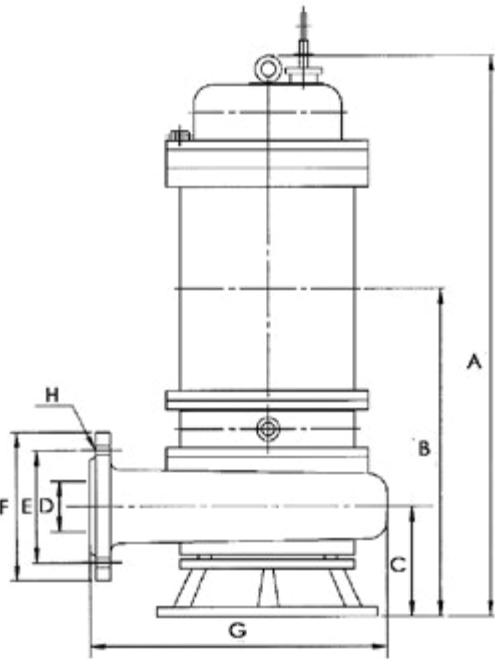

ALFA POMPE
ITALIAN PUMPS FOR HEAVY DUTY SOLUTION

DIMENSIONAL DRAWING

TYPE:

NAUTILUS

SUBMERSIBLE PUMP FOR DECANter FEED

R

FIELDS OF APPLICATION:

Submersible pump used to feed decaners with abrasive liquids produced in the marble and granite industry, in washing aggregates or in the ceramic industry. It is placed inside deep tanks or wells where a vertical pump cannot be used.
The capacity range of the NAUTILUS pumps is up to 2250 l/min.

TECHNICAL FEATURES

- AXIS:** Vertical pump with IMPELLER directly connected to the motor shaft with oil bath lubricated bearings.
- BODY:** Made of cast iron, divided into two parts, and coated with a wear-resistant compound. Replaceable and adjustable anti-abrasive rubber shells for quick maintenance.
- IMPELLER:** Non-clogging open type impeller, consisting of a steel core coated with a special anti-abrasive compound.

STANDARD EQUIPMENT

- Humidity probe
- Temperature probe

SECTORS

MARBLE
GRANITE
AGGREGATES
RECYCLING
INDUSTRIAL

MADE IN ITALY



OPERATING CHARACTERISTICS

PUMPS	FLOW RATE														SPEED (RPM)	MOTOR* (kW)
	m³/h l/1'	6	9	12	18	24	30	45	60	75	90	105	120	135		
NTL45	HEAD (m)	11	10,5	10	8,5	7	-	-	-	-	-	-	-	-	1425	4
NTL75		-	-	-	17,5	17	16,5	15	13	11	-	-	-	-	1455	7,5
NTL75S		-	-	-	-	20,5	20	18,5	16,5	14,5	12	-	-	-	1450	11
NTL100/325		-	-	-	-	-	31	30	29	28	26	24	22	20	1450	22

*Indicative data; measurement made with water; motor sizes may vary when working with high-density sludge.

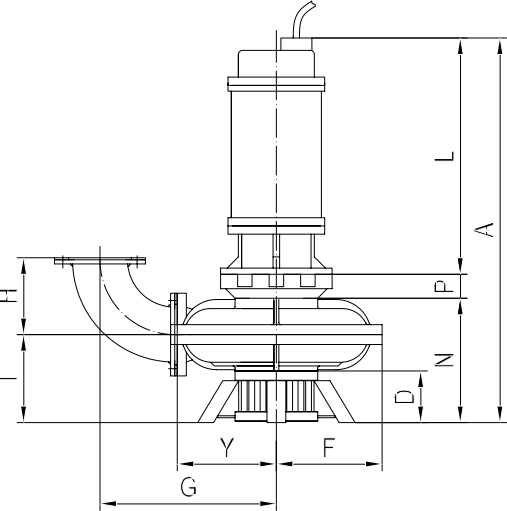

DIMENSIONAL

PUMPS	SIZE (mm)																	DN Out.	WEIGHT [KG]
	A	D	F	G	H	I	K	L	N	O	P	S	U	V	W	Z	Y		
NTL45	786	121	175	370	165	181	-	505	241	350	40	628	N°4 HOLES Ø14	165	-	125	205	50	110
NTL75	859	121	256	427	187	208	456	505	296	512	58	793	N°4 HOLES Ø14	220	160	180	240	100	193
NTL75S	954	121	256	427	187	208	456	600	296	512	58	793	N°4 HOLES Ø14	220	160	180	240	100	223
NTL100/325	1363	200	360	507	187	311	565	822	496	720	45	977	N°4 HOLES Ø14	220	250	180	320	100	418

Indicative dimensions and weights

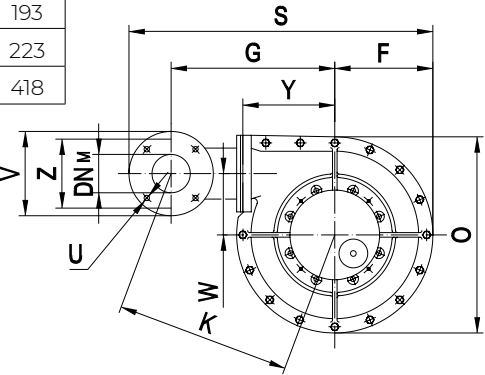

ALFA POMPE
ITALIAN PUMPS FOR HEAVY DUTY SOLUTION
DIMENSIONAL DRAWING

TYPE:

SHARK

R

SUBMERSIBLE PUMP FOR FEEDING DECANTERS WITH ABRASIVE LIQUIDS

FIELDS OF APPLICATION:

Submersible pump used to feed decanters with abrasive liquids produced in the marble and granite industry, in washing AGGREGATS or in the ceramic industry. It is placed inside deep tanks or wells where a vertical pump cannot be used. The IMPELLER is open type, is metallic and has improved performance and efficiency compared to a rubberized IMPELLER; this means that a lower power motor can be fitted for the same performance. The flow rate range of SHARK pumps is up to 5800 l/min.

TECHNICAL FEATURES

- AXIS:** vertical pump with IMPELLER directly connected to the motor shaft with oil-bath lubricated bearings.
- BODY:** cast iron, divided into two parts and coated with anti wear compound. Replaceable and adjustable anti-abrasive rubber shells for fast maintenance.
- IMPELLER:** anti-clogging open metal that improves efficiency, allowing smaller engines the same performance.

STANDARD EQUIPMENT

- Humidity probe
- Temperature probe

SECTORS

MARBLE
GRANITE
AGGREGATES
RECYCLING
INDUSTRIAL

MADE IN ITALY



OPERATING CHARACTERISTICS

PUMPS	FLOW RATE									SPEED (RPM)	MOTOR* (kW)
	m³/h	0	50	100	150	200	250	300	350		
	l/1'	0	830	1660	2500	3300	4150	5000	5800		
SRK 125 Ø330	HEAD (m)	37	35,5	33	28	22,5				1450	30
SRK 125 Ø350		42	40.5	38	35	31	26.5	22		1450	37
SRK 125 Ø370		47	45.5	43.5	41	37.5	34	29.5	25	1450	45
SRK 125 Ø400		54.5	54	52	49	46	42.5	38	33	1450	55

*Indicative data; measurement made with water; motor sizes may vary when working with high-density sludge.

DIMENSIONAL

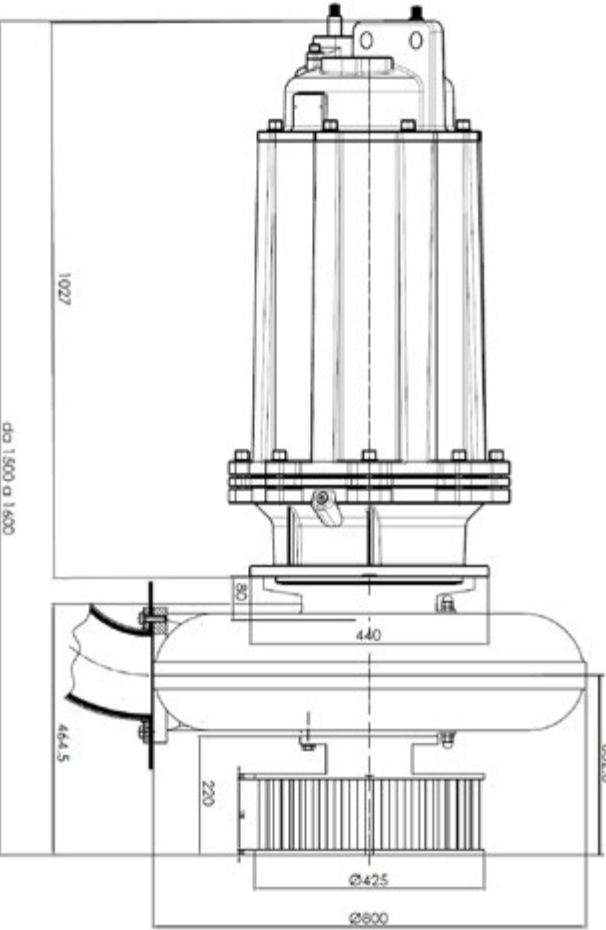
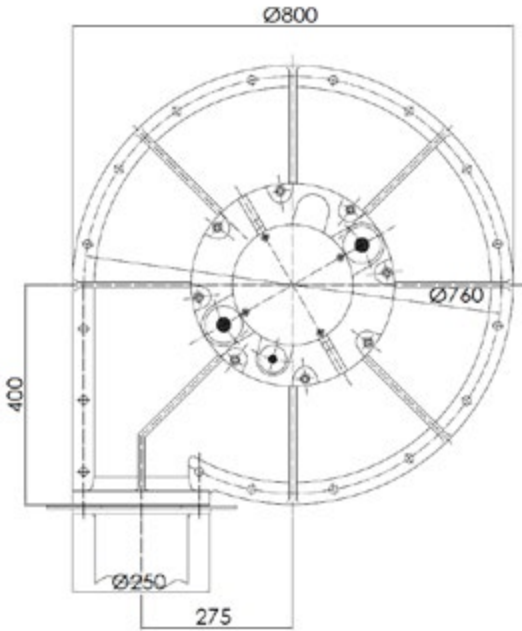

ALFA POMPE
ITALIAN PUMPS FOR HEAVY DUTY SOLUTION
DIMENSIONAL DRAWING



ACCESSORIES AND SERVICE

Alfa Pompe is distinguished by its wide availability of accessories, made possible by a large warehouse with over 2000 references in stock. With a wide range of components always on hand, we guarantee fast response times and efficient deliveries.

From gaskets to valves, our warehouse boasts a comprehensive inventory, enabling us to promptly meet the different needs of our customers. This extensive stock not only ensures smooth operations, but also underlines our commitment to customer satisfaction.

With Alfa Pumps, customers can count on the accessibility and reliability of our accessories, facilitating operations and minimising downtime, thus improving productivity and promoting long-term partnerships.

PRODUCTS:

VALVES

PIPES AND FLANGES

SPARE PARTS

SLEEVE VALVES

VPA - VPA2 PNEUMATIC CONTROL

TECHNICAL FEATURES

Manually operated valves with aluminium BODY and rubber sleeve designed for abrasive mixtures. Depending on the internal diameter of the sleeve, they are manufactured with either external or internal clamps. Pneumatically actuated valves (open pressure) have an aluminium BODY and rubber sleeve designed for abrasive mixtures. They are produced with single or double cylinder. In the rest position they are closed and opening occurs with the air supply.

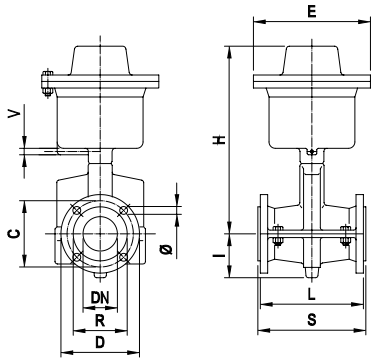

1-cylinder valve (type 1c) "vpa"

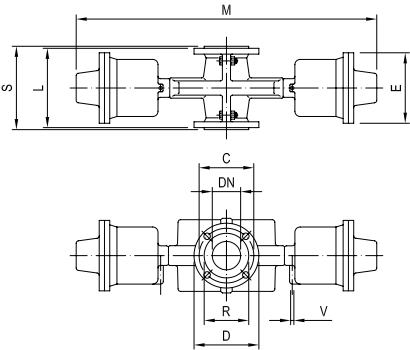

2-cylinder valve (type 2c) "vpa2"

VALVE	TYPE	SIZE (mm)										WEIGHT (Kg)		
		DN	E	H	I	L	S	M	V	FLANGE				
										C	D		HOLE	
													diam.	N.
VPA 25	1C	25	150	265	40	160	170		1/4"G	85	115	14	4	5,2
VPA 40	1C	40	200	365	50	200	210			110	150	18	4	11
VPA 50	1C	50	200	380	55	230	240			125	165	18	4	12
VPA 65	1C	65	200	400	60	290	305			145	185	18	4	16
VPA 80	1C	80	285	560	180	310	330			160	200	18	4	32
VPA 100	1C	100	285	575	205	350	370			180	220	18	8	33
VPA 125	1C	125	375	920	210	400	420			210	250	18	8	68
VPA 150	1C	150	375	940	245	480	500			240	285	22	8	75
VPA 200	1C	200	450	1100	320	600	620			295	340	22	8	135
VPA280	2C	80	165	-	-	250	270	675		160	200	18	4	28
VPA2100	2C	100	200	-	-	300	320	700		180	220	18	8	30
VPA2125	2C	125	245	-	-	300	320	870		210	250	18	8	47
VPA2150	2C	150	245	-	-	300	320	900		240	285	22	8	55
VPA2200	2C	200	285	-	-	340	360	1030		295	285	22	8	72

Indicative dimensions and weights



PIPES AND FLANGES

SPECIAL ANTI-ABRASIVE HOSES AND HOSE FLANGES IN ANTI-ABRASIVE RUBBER

SPECIAL ANTI-ABRASIVE HOSES

PIPES			
CODE	A	B	WEIGHT (Kg)
TUG35	35	49	1,3
TUG60	60	70	1,8
TUG68	70	80	2,3
TUG99	101	111,5	3,5
TUG100	100	130	9,1
TUG125	127	155	10,5
TUG150	152	184	15
TUG180	180	205	12,2
TUG200	203	230	16,4
TUG250	254	285	22,7
TUG300	305	336	27,9

STEEL FLANGES								
CODE	SIZE					HOLES		WEIGHT (Kg)
	DN	C	D	S	Diam.	n°		
FA25	25	85	115	10	14	4	0,6	
FA50	50	125	165	10	14	4	1,5	
FA70	70	160	200	10	14	4	2	
FA100	100	180	220	10	14	4	2,2	
FA125	125	210	250	10	16	4	2,5	
FA150	150	240	285	10	16	4	3,3	
FA170	170	270	315	10	16	8	3,8	
FA200	200	295	340	10	16	8	4	
FA250	250	350	395	20	20	12	14	
FA300	300	400	445	20	22	2	17	

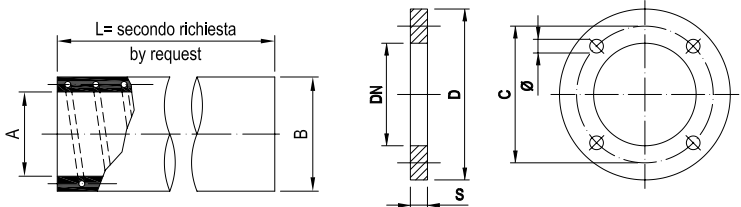

ANTI-ABRASIVE RUBBER HOSE FLANGES

ALUMINIUM FLANGES FOR RUBBER PIPES										
CODE	TYPE	C	D	E	I	L	S	HOLES		WEIGHT (Kg)
								Diam.	n°	
FB25	1	85	115	33	-	100	10	14	4	1
FB50	1	125	165	60	-	90	10	14	4	1,9
FB70	1	160	200	70	-	90	10	14	4	3
FB99	1	180	220	100	-	160	10	14	4	3,2
FT100	2	180	220	-	127	155	20	16	4	3,6
FT125	2	210	250	-	154	160	22	18	4	4,4
FT150	2	240	285	-	183	180	22	18	4	6
FT170	2	270	315	-	204	200	25	18	8	8,2
FT200	2	295	340	-	229	200	25	18	8	8,5
FT250	2	350	395	-	284	250	20	20	12	25
FT300	2	400	445	-	335	250	25	22	12	33

TYPE "1" FLANGE (one-piece steel)

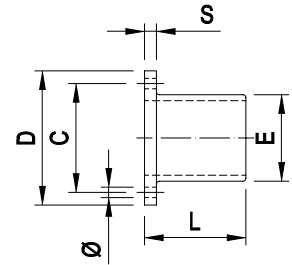

TYPE "2" FLANGE (one-piece aluminium)

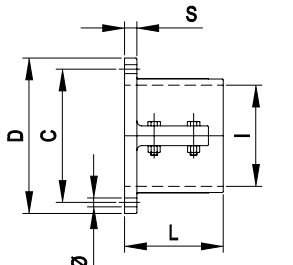

Alfa Pompe stands out in the market as a reliable supplier of pump accessories, not only for its own product range, but also for those of other renowned brands. The extensive range of accessories offers customised solutions to meet the specific needs of customers in various industrial sectors, including mining, construction, food and chemical industries.

An exploded view diagram of a mechanical assembly, likely a pump or motor. The components are arranged in a linear sequence from left to right. On the far left is a blue, cast-iron housing with a flange. Next to it is a silver, cast-iron impeller with a central hub and four curved blades. This is followed by a silver shaft with a central hub and a flange. To the right of the shaft is a blue, cast-iron housing with a flange. Further right is a silver shaft with a central hub and a flange. To the right of this shaft is a blue, cast-iron housing with a flange. On the far right is a motor unit with a silver base and a blue top. The components are shown in an exploded view, indicating their relative positions and assembly order. The background is white with a light gray circular gradient.

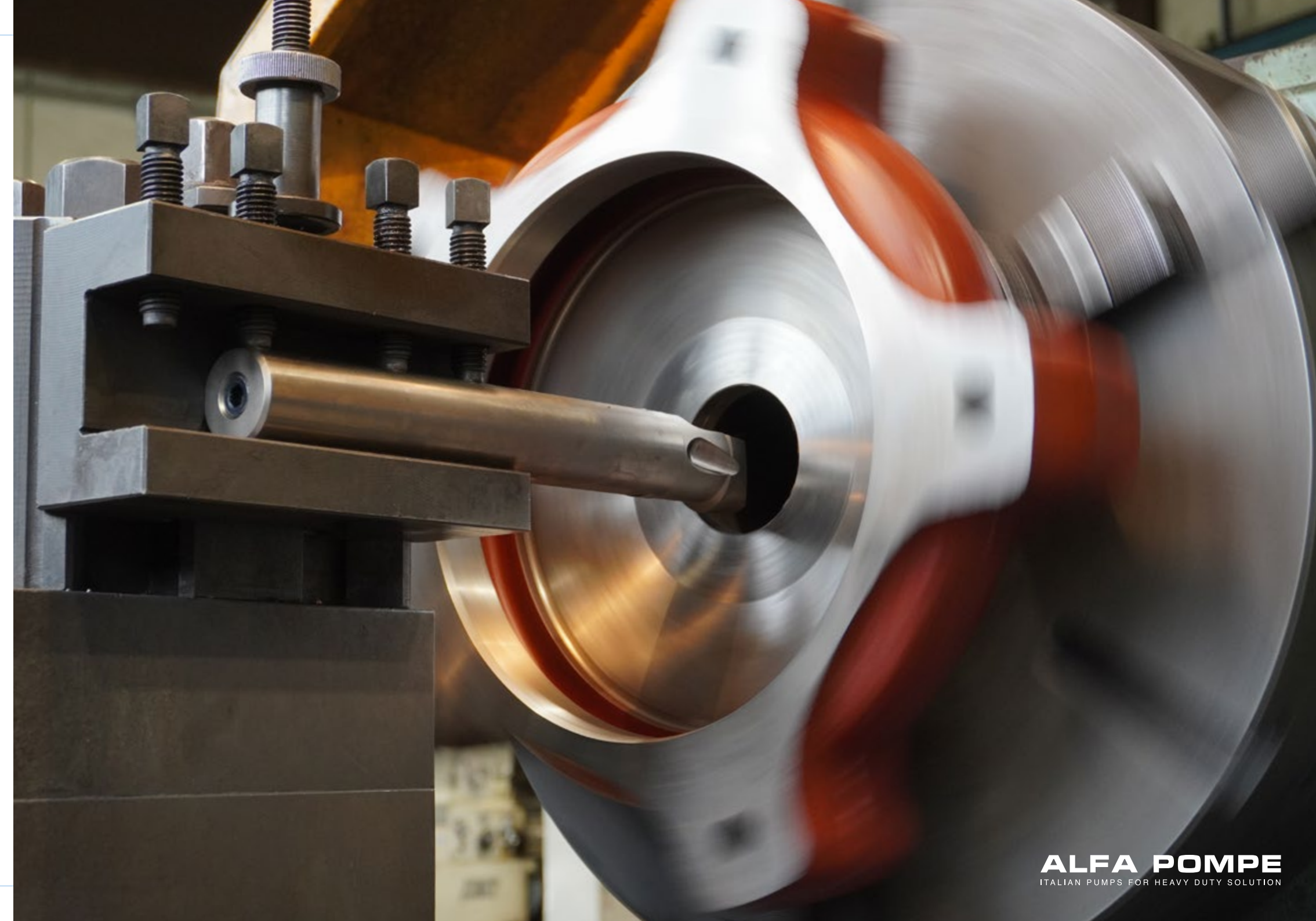

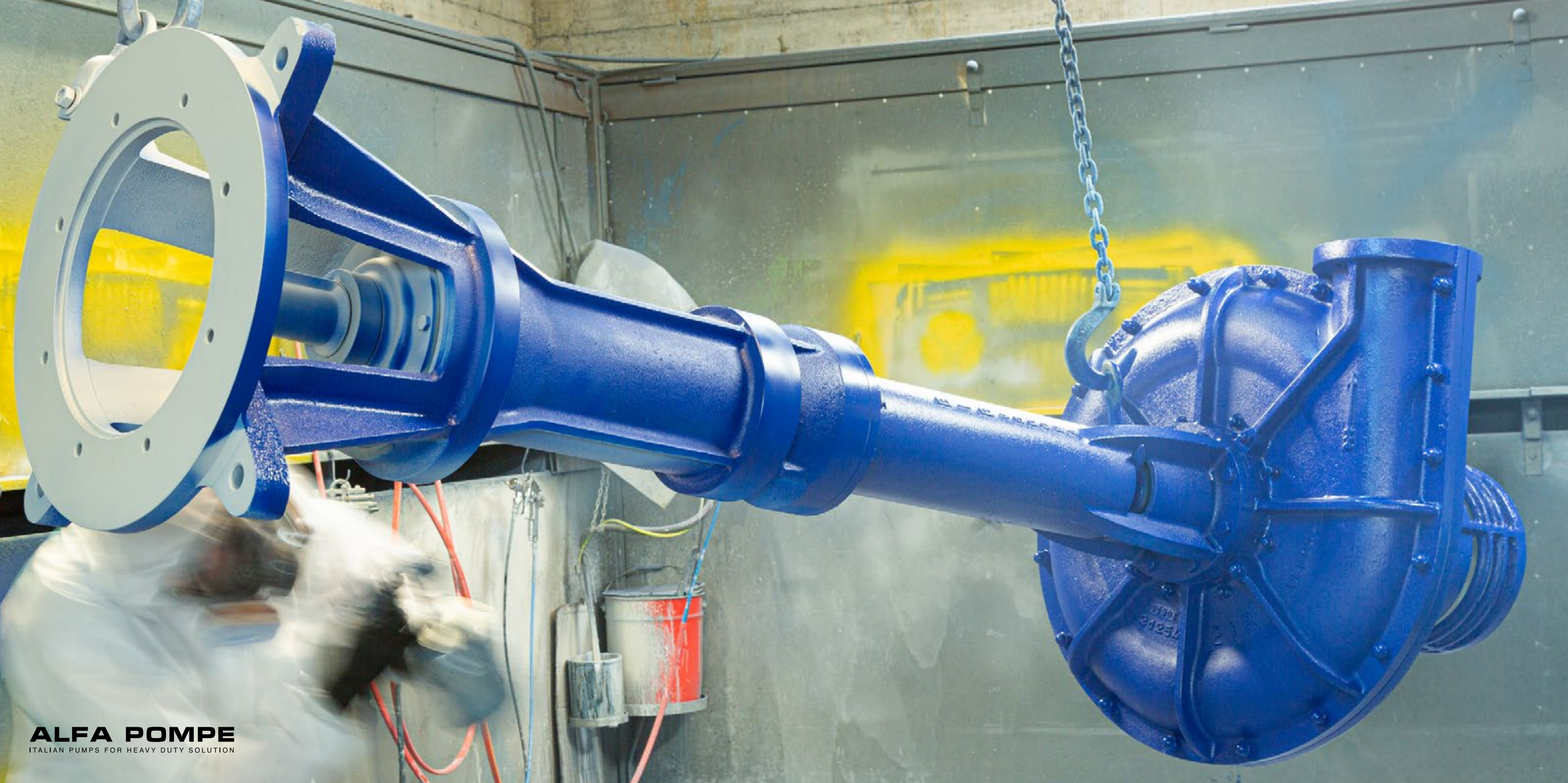

CHOOSE YOUR COLOR

We offer our customers the opportunity to customise their pumps, including the choice of desired colour. We recognise the importance of accommodating individual preferences and providing tailor-made solutions that perfectly match each customer's needs and style.

Each customised pump is produced to the same high standards of quality and reliability that set us apart, ensuring customers receive a pump that not only stands out for its aesthetic appearance, but also for its efficiency and durability.



COLOUR STANDARD
RAL 5002



CUSTOMIZED RAL





www.alfapompe.it

Via Trento 132/A
37020 Dolcè Verona (VR) - Italy
Tel: +39 045 7290055
info@alfapumps.it
P.IVA / VAT: IT00235680238